

**NEW CATALOGUE
COMING SOON**

AHT

1992



2012

BESCHLÄGE



HARDWARE

FERRAMENTA



QUINCAILLERIE

Our company	Company-profile - Our mission	01
Handles	Handles metal Handles wood	02 - 05 06
Furniture legs	Height-adjusters/Levellers	07
Shelf-supports	Glass-shelf supports	11
Wall shelf-supports/ consoles	Wall shelf-supports for invisible built-in Clam wall shelf-support ALU for glass-thickness 8 mm	12 - 14 17
Opening and closing	Dampers for doors and flaps SLOWCLOSE Opener for doors and flaps without handles TOUHLATCH	18 19 - 20
Flap fittings	Flap lifter - Gas spring Flap stay - Gasbrake	21 22
	Worktop-/Rapid connectors with ZIPBOLT™ drive FASTFIT™ - rapid connector DAISY CATCH™ - special one part-catch	23 - 38 39 40
Kitchen hardware	Worktop connectors standard	41
Wardrobe accessories	Wardrobe-lifter LIFT 10 Wardrobe-lifter LIFT 15 Tie- and belt-holder, swivel-type	43 - 44 45 - 46 47
Hinges	Stainless steel hinges	52 - 53
OEM parts acc. to drawing	Metalstamping/Curved parts	55
Examples	Levellers/Bar-console supports/welding-groups Stamping-/Curving-/deep-draw parts	57 58

AHT-Beschläge GmbH, was founded in Solingen (Germany) on the 16th of October, 1992 from Arne Hammesfahr and Elio Tommaso. The company specialised in the development and the distribution of hardware for the furniture-industry and in the beginning the focus was set on the production of special OEM parts. Due to the experience which the company made with the German furniture-industry and due to the good contacts to foreign markets, such as Italy, where on the 1st of July, 2001 a branch-office has been established, the AHT product-range has been continuously developed further.

Today AHT can offer contemporary products at attractive conditions to customers in the woodworking-, automotive- and metalworking industry, despite today still an important share of the business-volume can be attributed to special OEM products. Thanks to the cooperation with the Italian company EFFEGI BREVETTI in 1994 the product-range has been completed with a vast number of innovative items, which have set global trends in the furniture-production. The start of the cooperation with the Australian company ZIPBOLT™ on the German and Italian market, in January 2007, represents an important enrichment of our product-range.

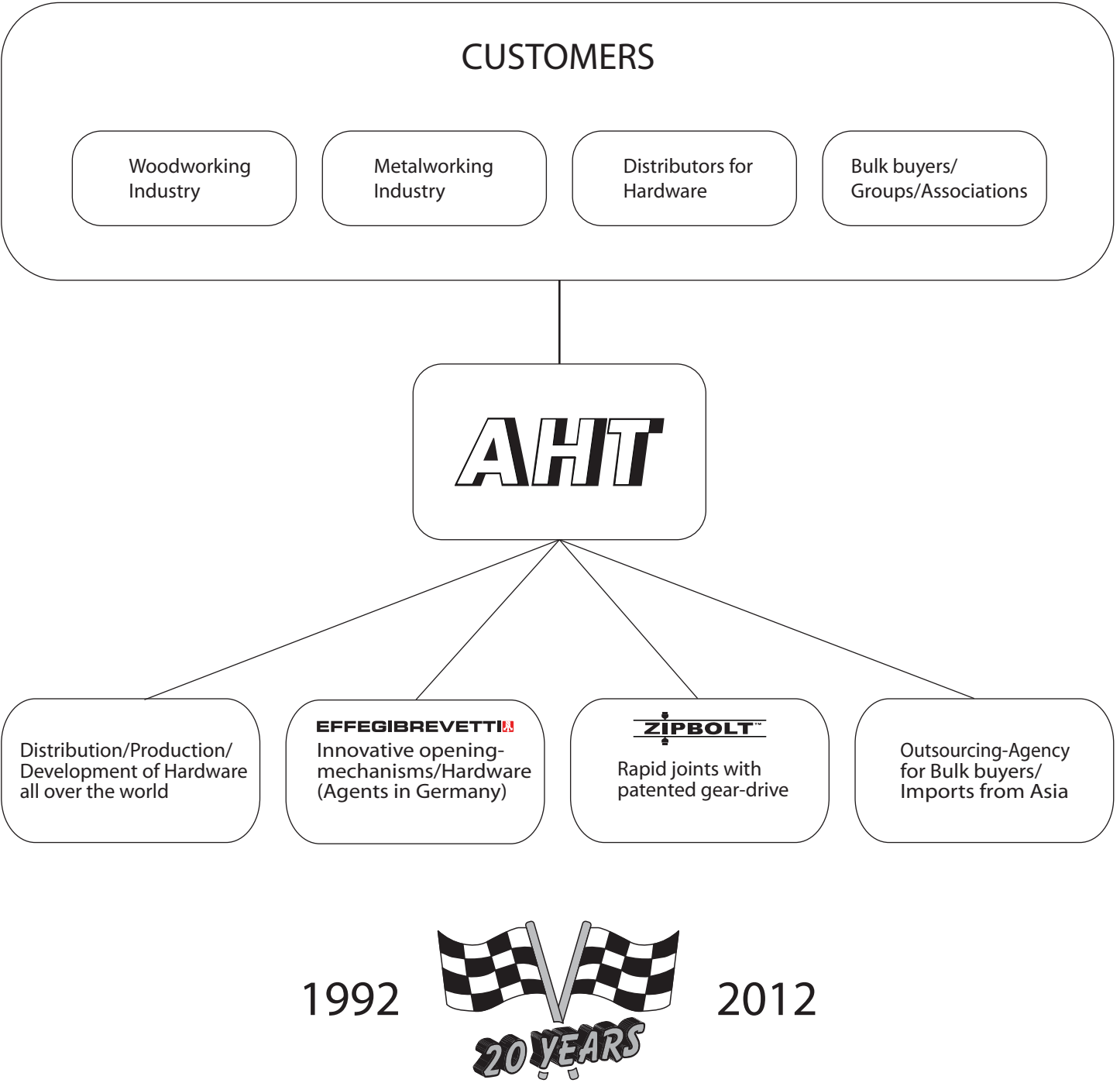



ALUMINIUM



Art.	L	B	H	LA
HI-1001778	155	16	27	128

STEEL



Art.	L	B	H	LA
1813.002	228	10	32	192



ZINC



Art.	L	B	H	LA
1860.002	150	13	30	128



ZINC

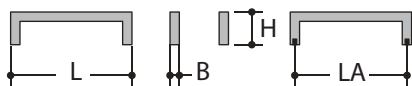

Art.	L	B	H	LA
50567.002	140	12	27	128

ZINC



Art.	L	B	H	LA
1824.001	192	19	28	160

ALUMINIUM



Art.	L	B	H	LA
1816.001	105	10	35	96

ALUMINIUM

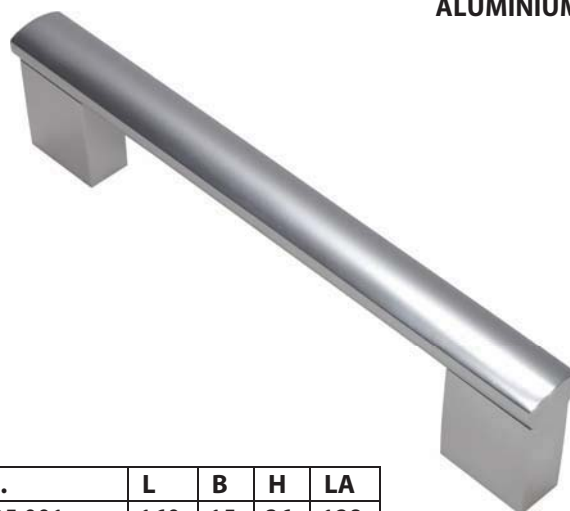

Art.	L	B	H	LA
1825.001	160	15	36	128

STAINLESS

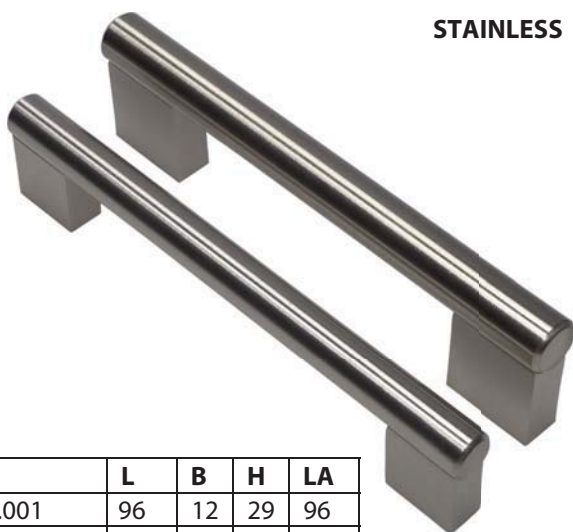

Art.	L	B	H	LA
1826.001	96	12	29	96
1826.002	145	14	39	128

ZINC



Art.	L	B	H	LA
1827.001	141	14	32	128

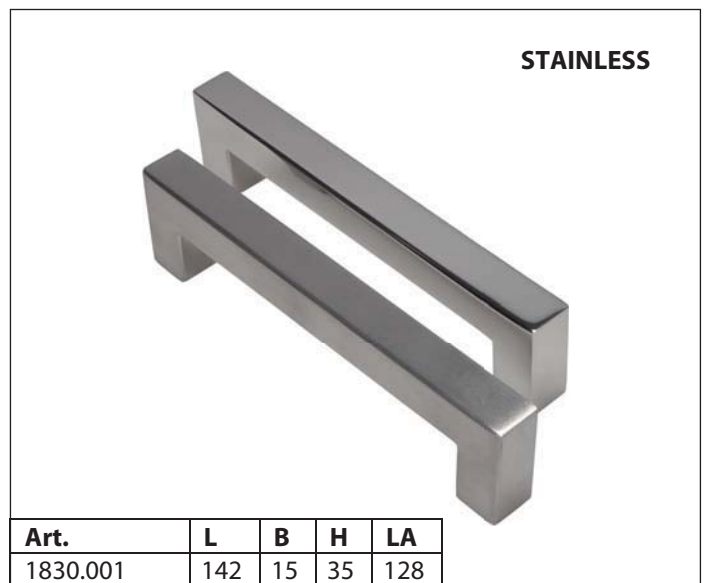
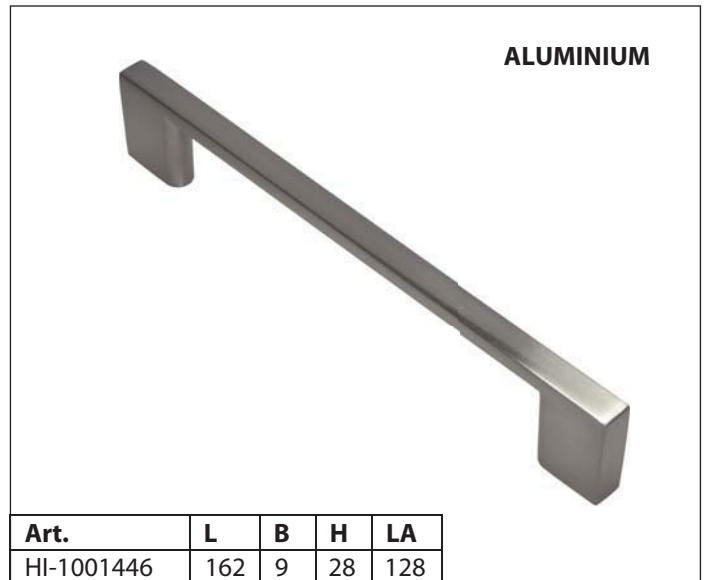

ZINC

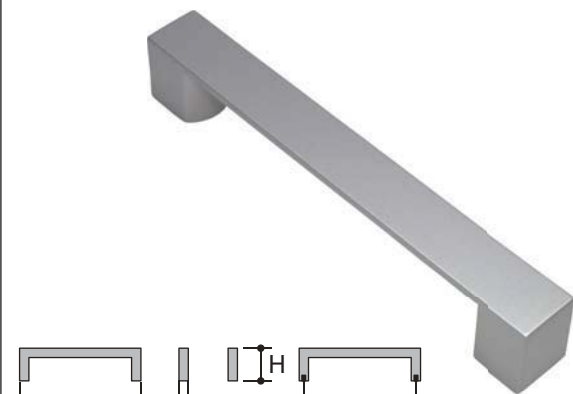

Art.	L	B	H	LA
1870.003	160	20	27	128

ZINC



Art.	L	B	H	LA
1827.001	135	12	27	128

ZINC



Art.	L	B	H	LA
1800275.001	190	14	31	160

LASER-MARKING



Handles can be marked with customer-names/
Logos/Brands.
Non-destructive by Laser-Technology.

STEEL



Art.	L	B	H	LA
1803.188	188	12	35	128



Art. 120020.001



Art. 120021.001

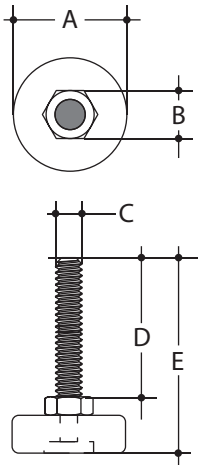

Art. 120020

Material: plastic/steel
Finish: zinc-plated

Art. 120021

Material: stainless steel/steel
Finish: natural/zinc-plated

Art.	A	B	C	D	E
120020	Ø 38	SW13	M8	60	74
120021	Ø 35	SW11	M8	16	31



Art. 120022.001



Art. 120023.001

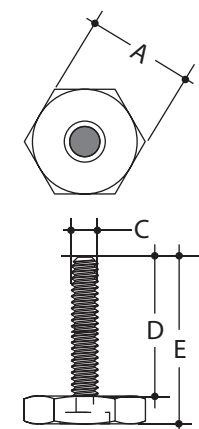

Art. 120022

Material: plastic/steel
Finish: zinc-plated

Art. 120023

Material: steel
Finish: zinc-plated

Art.	A	C	D	E	
120022	25	M8	45	55	
120023	30	M8	45	50	



Art. 56802.02

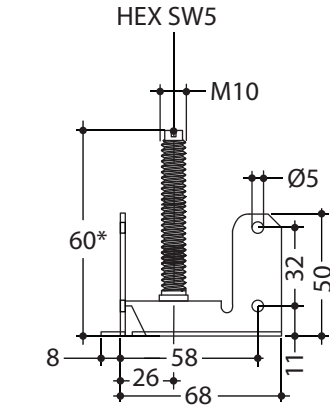

Plinth, height adjuster
M10 x 50 mm,
with hexagon slot SW5,
foot-Ø 45 mm,
with link for plinth

Material: steel
Finish: zinc-plated

*other lengths on demand



Art. MW-EY1279

Special part according to customer-drawing

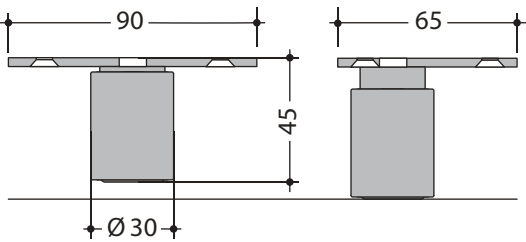

Height-adjuster made of 2 parts, M8 x 40 mm



Art. 110019.001

Clamp-Shelf support

Glass-Thickness: 4 - 8 mm
 Material: zamak/plastic
 Finish: nickel-plated/neutral
 Packing: 500 pcs./carton

Shelf-width G = Inner width B - 7 mm

1. insert base-part

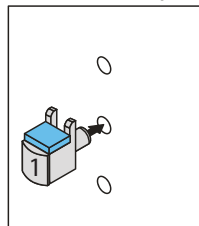

into boring

2. place

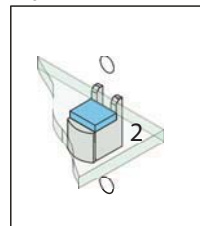

glass-shelf

3. clip-in

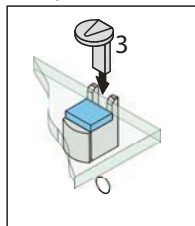

upper part

glass-shelf

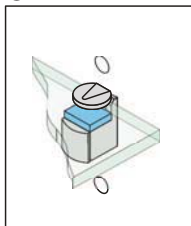

safely blocked

to disengage

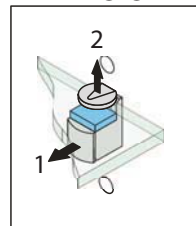

pull/lift

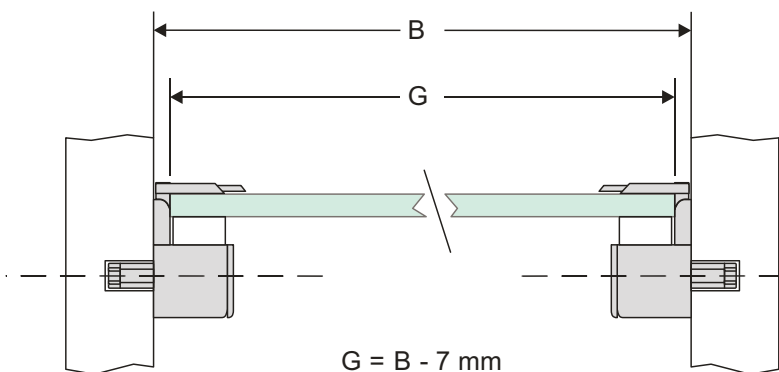
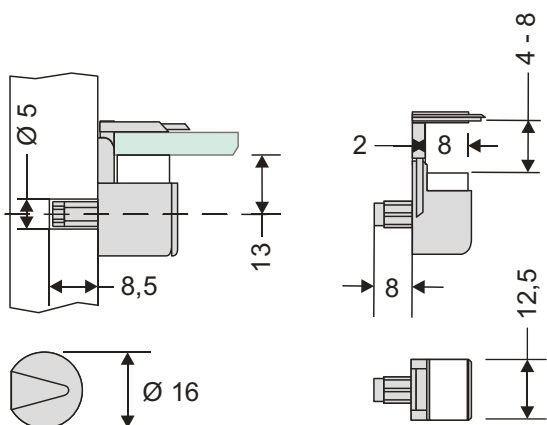

Art. 110030

Lay on shelf-support

Material: zamak/plastic
 Finish: nickel-plated/neutral

Packing: 500 pcs./carton

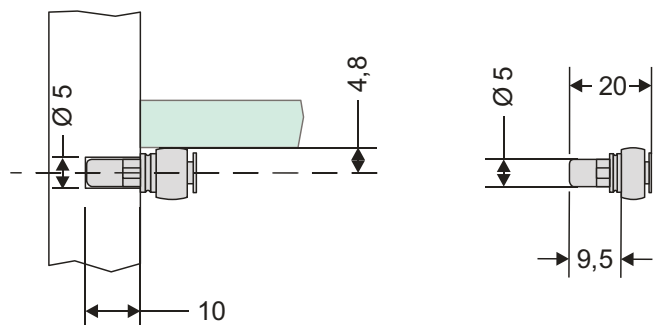

BUILT-IN SHELF SUPPORTS

Built-in shelf supports, tridimensional adjusting, height, side-position and inclination adjustable.

- Height-adjusting through long-holes
- Side-position adjustable, loosen and shift the position of steel-bolt within long-hole
- Inclination adjustable with 2 M6-screws with cross-slot

Safe and precise mounting due to solid mounting-plate with long-holes.

Precise adjustment of inclination with the 2 integrated M6 adjusting-screws.

Solid hexagon- or round bolt for support of wood-shelf.

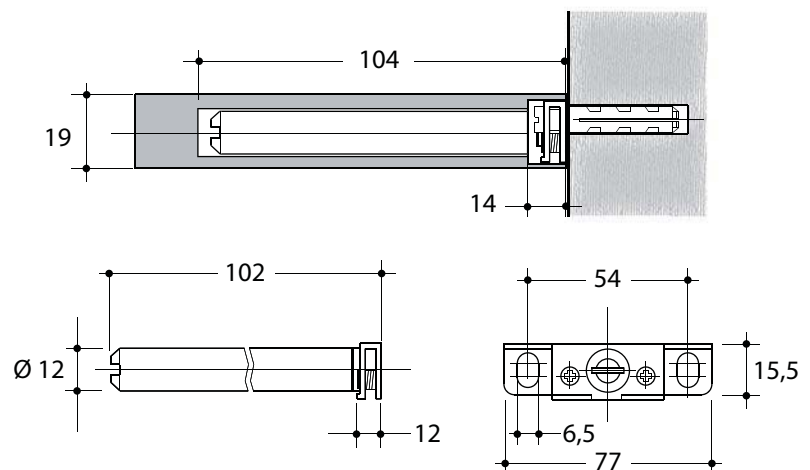
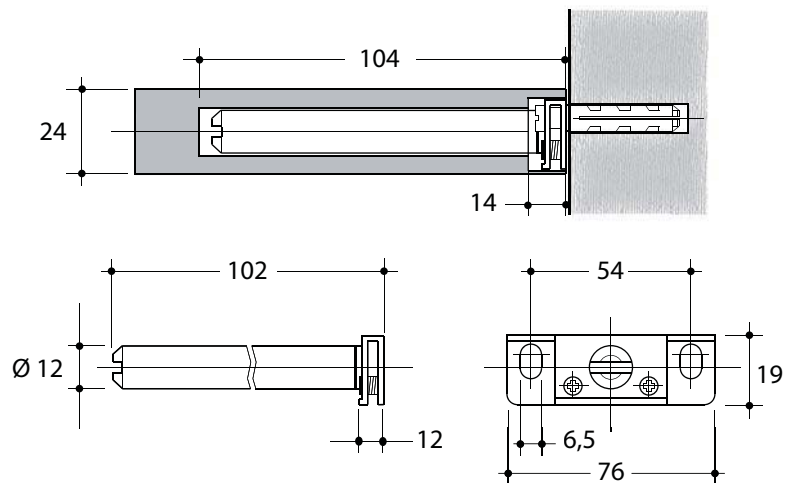
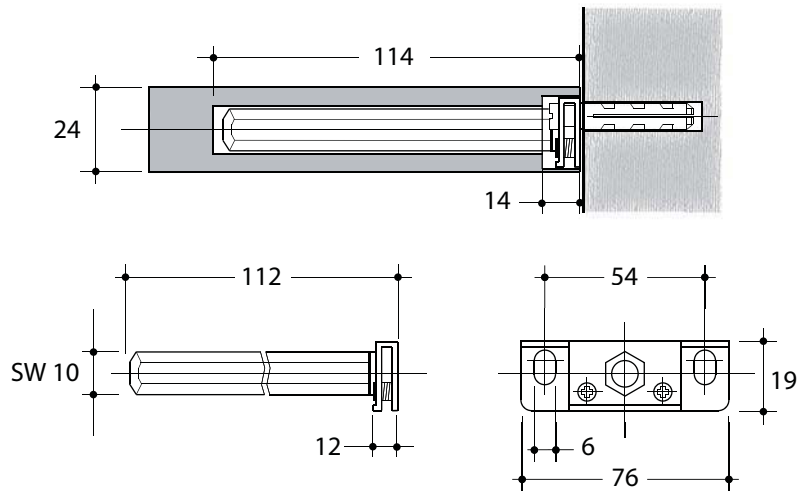

Shelf-support with height-, side- and inclination-adjustment

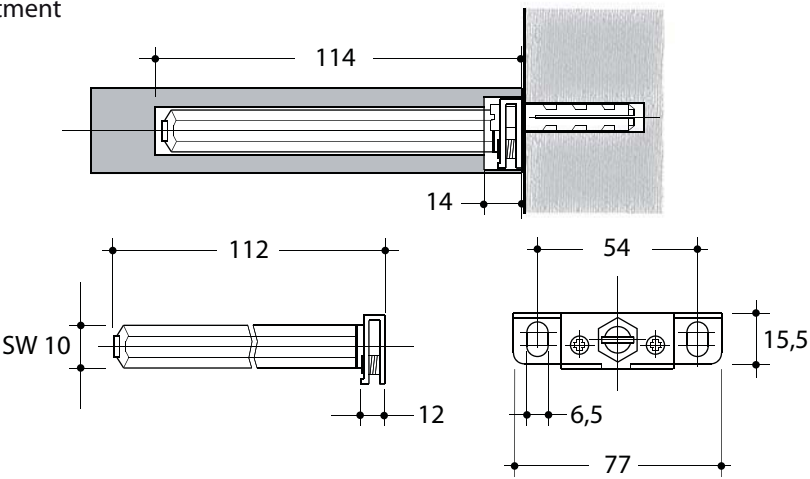



Built-in shelf support, with inclination-adjustment, tube \varnothing 20 mm, length 300 mm, thickness 1,4 mm, fixing-plate 110 x 30 x 4 mm, steel silver colour,

Packing:

every set in polybag with fixing-material for panel- and wall-fixing

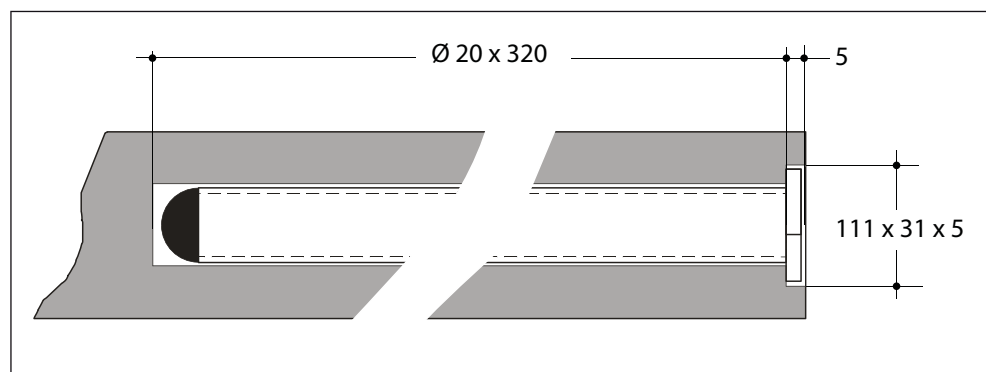



Glass-shelf support **ALU**,

2 transparent rubber-cords assure a safe hold of the glass-shelf, with plastic-screw for fixing of glass-shelf, for glass-thickness 8 mm.

Sizes: 38 x 35 x 72 mm (WxHxD)

Material: Aluminium

Finish: silver anodized

Accessories for panel-fixing:

Screw M8 x 25 mm , steel zinc-plated

Bush M8 x 11 mm, steel zinc-plated

Screws and anchors for wall-fixing on request.

Panel-fixing

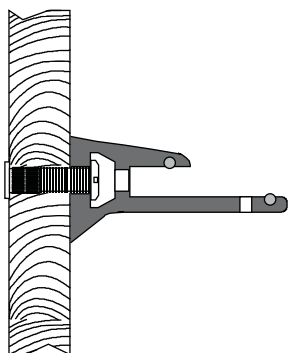

Wall-fixing

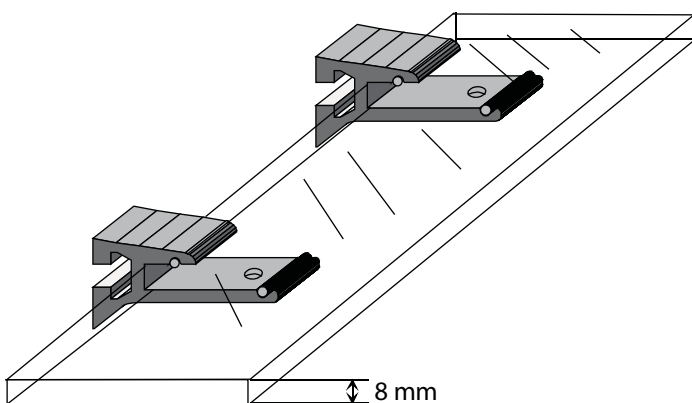
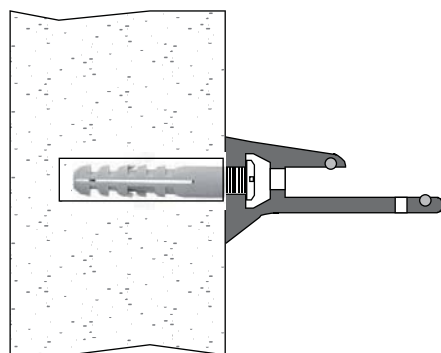

SLOWCLOSE FOR DOORS

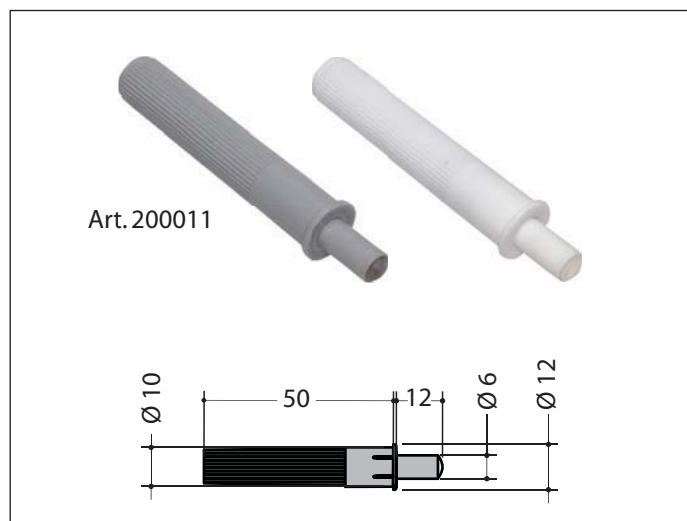

SLOWCLOSE is available in 3 different damper-forces (SOFT/MEDIUM/STRONG), depending from the desired position inside the cabinet.

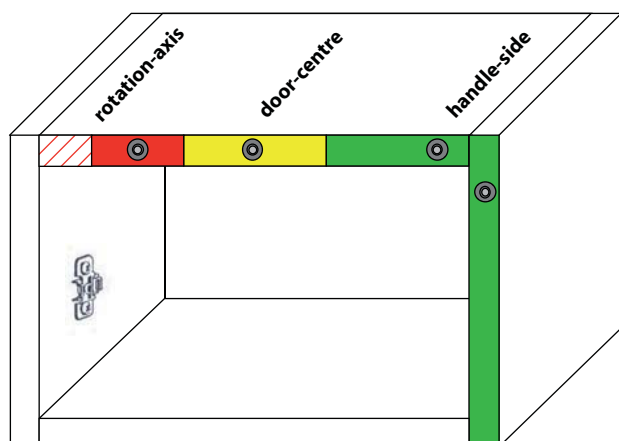

Door shock-absorber **SLOWCLOSE** for furniture doors, flaps and drawers.

Slows down the door/flap/drawer with it's oil-dynamic attenuation-mechanism and guarantees silent and comfortable closing.

Simple installation:

The shock-absorber can be inserted into the top-/ bottom-shelf or into the side-panel with a bore-hole Ø 10 x 50 mm or fixed with wood-screws with the (optional) mounting-plate.

Packing/weight: 1.000 pcs./box - 5.5 kgs

Colours:

white/brown/grey - other colours on demand

 = Min. distance approx. 30 mm

 = **SLOWCLOSE** STRONG - Installation on hinge side

 = **SLOWCLOSE** MEDIUM - Central installation

 = **SLOWCLOSE** SOFT - Installation on handle side

ATTENTION:

THE OPTIMAL POSITION IS DETERMINED THROUGH THE FURNITURE-MAKER, DEPENDING FROM THE USED COMPONENTS.

WE RECOMMEND TO MAKE RESPECTIVE TESTS FIRST.

Mounting-plates

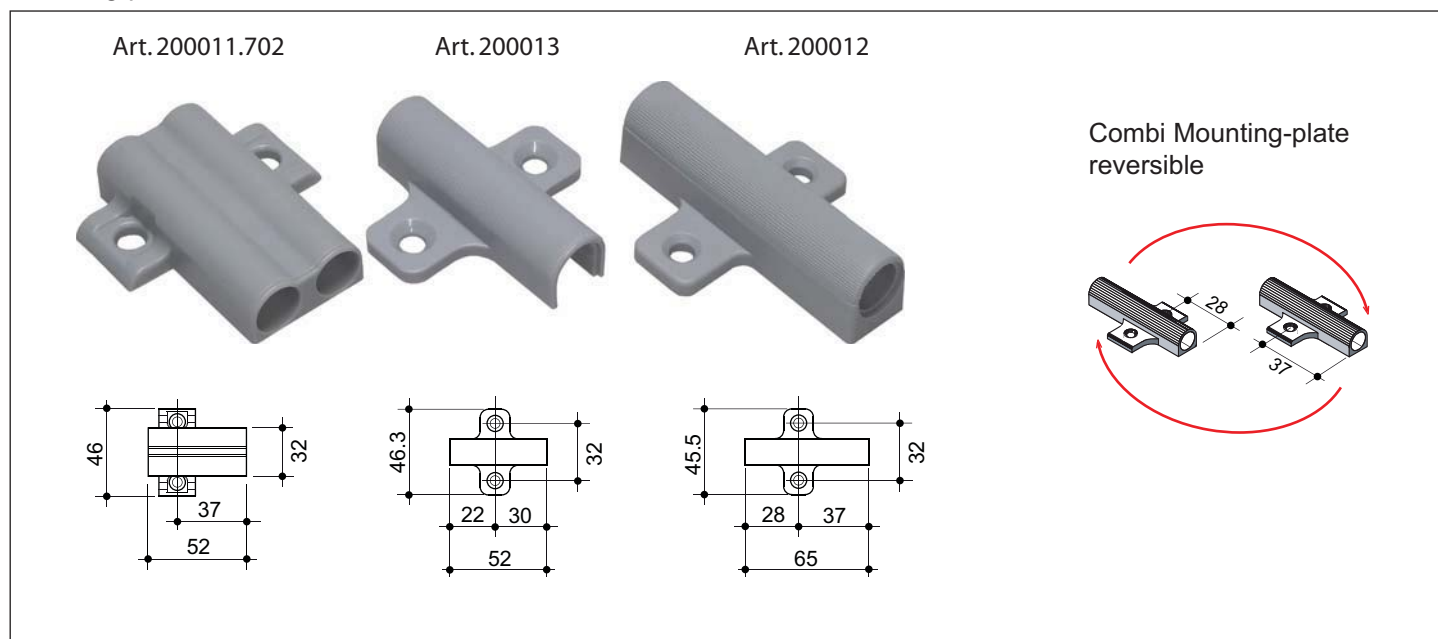



TOUCH LATCH,

Permits the opening of doors without handles , by a slight touch of the door-frontal.

Short version,

for overlapping doors and low door-heights;
e.g. kitchen-cabinets.
Opening approx. 20 mm
plastic, grey

without magnet:	Art. 200030.020
with magnet:	Art. 200030.M20

Fixing with screw-on mounting-plate or with adapter for built-in mounting Ø 12 mm



Long version,

for inlet-/ and high doors;
e.g. kitchen larder-cabinets.
Opening approx. 40 mm
plastic, grey

without magnet:	Art. 200030.040
with magnet:	Art. 200030.M40

Fixing with screw-on mounting-plate or with adapter for built-in mounting Ø 12 mm



Accessories:

Mounting-plate without stop, for screw-on	Art. 200030.ON1
--	-----------------

Mounting-plate with stop, for screw-on	Art. 200030.MN1
---	-----------------

Self-adhesive counter-plate 20 x 20 x 1 mm, for screw-on	Art. 200030.MPL
--	-----------------

Adapter for built-in, boring Ø 12 mm	Art. 200030.H01
---	-----------------



Remark:

For the version with magnet, we recommend the use of hinges without spring, for a better opening-function.

TOUHLATCH Specifications

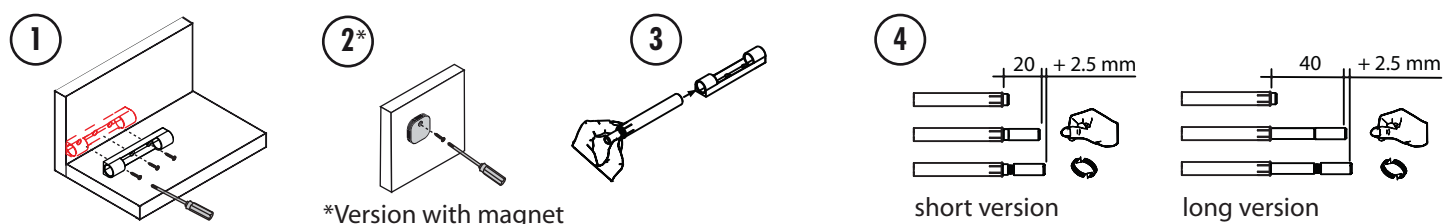

F = doorgap (adjustable)		
Model	min.	max.
Mounting-plate without stop, without magnet	1,5	4,0
Mounting-plate without stop, with magnet	2,5	5,0
Mounting-plate without stop, with magnet	2,2	4,7
Mounting-plate with stop, with magnet	3,2	5,7

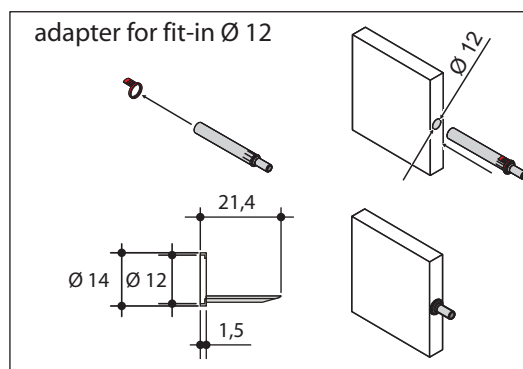
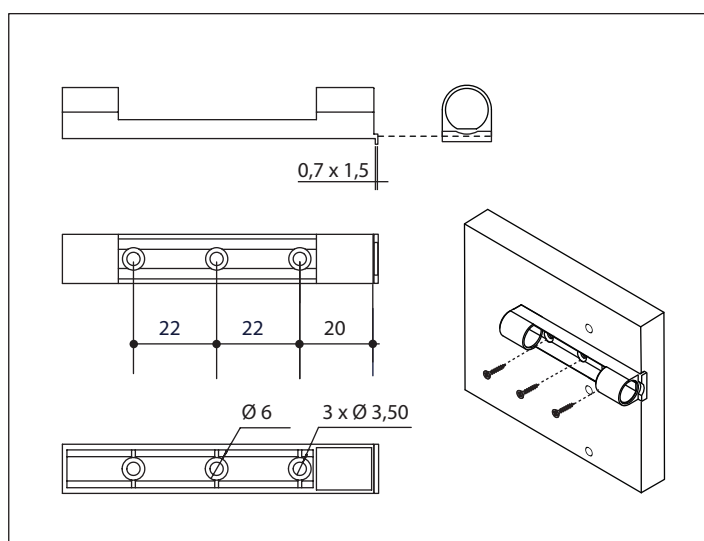
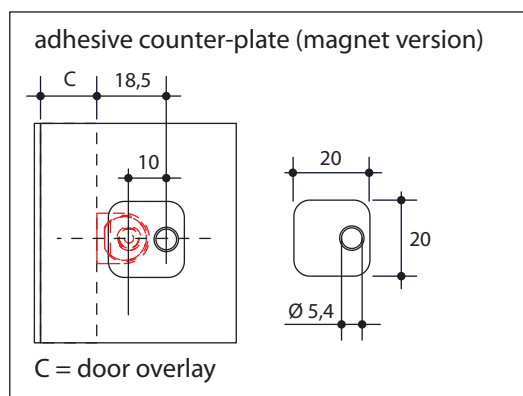
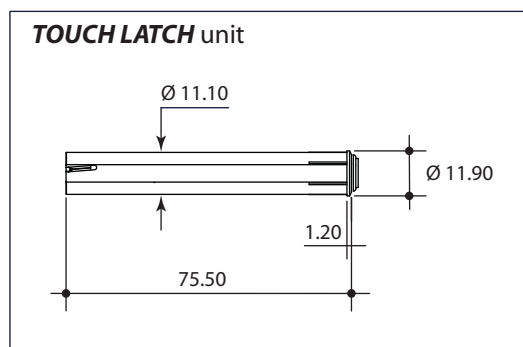
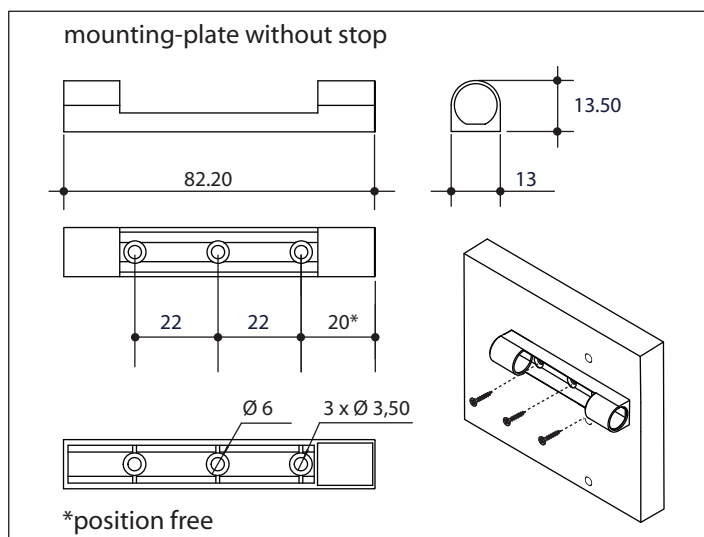
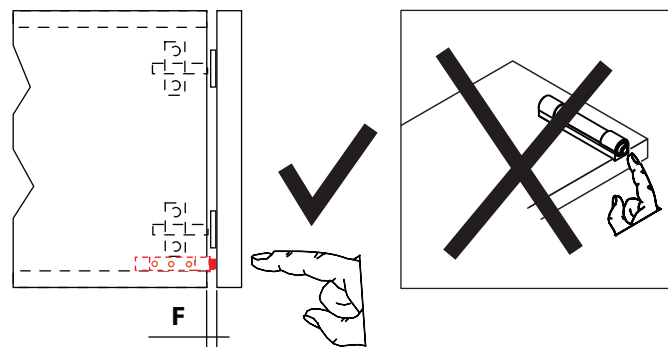

FLAP STAY



Gas spring/Flap stay

Version: Steel, silver lacquered

Loading: 60/80/100/120/140N

Example 1 piece 100N*

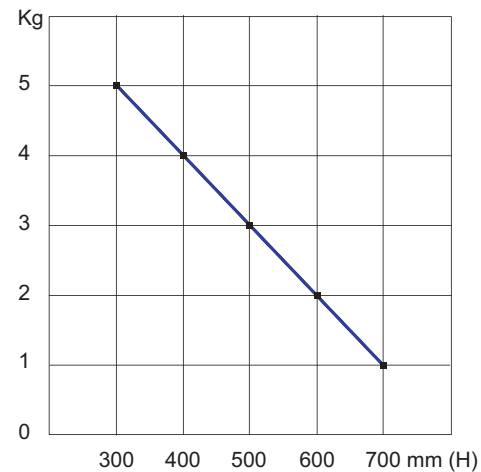

* Approximated guide-numbers. For the determination of the correct force, please make your individual tests.

For higher Flap-weights, please use 2 flap stays.

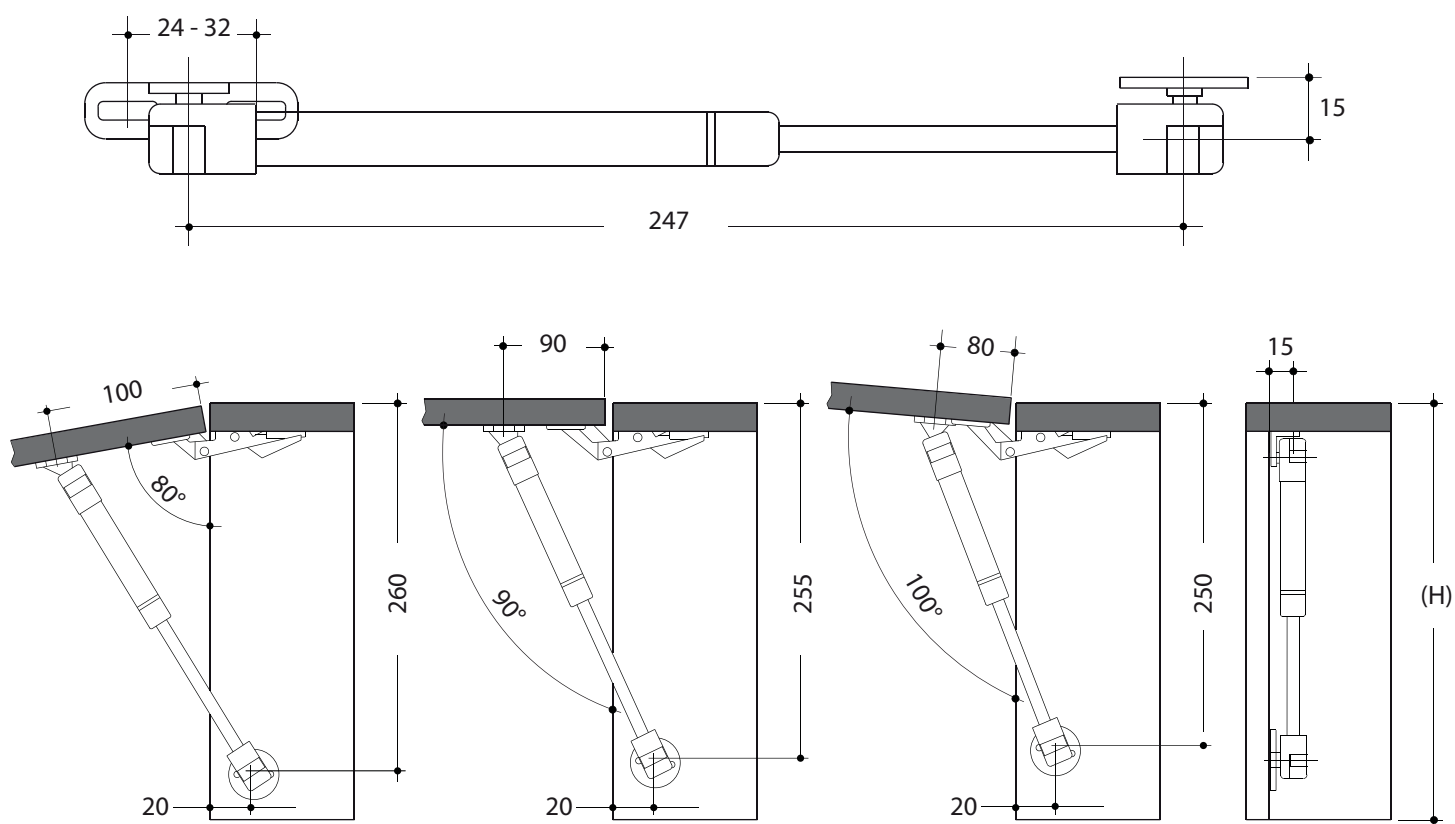

Flap Stay Gasbrake

slows down flaps and doors with downward opening and assures a soft closing.

Depending on the dimension and the weight of the door and according to the kind of hinges, which are used, the user can employ 1 or 2 gasbrakes.

Execution: Steel, silver lacquered

Fixing:

wood-door

Alu-Frame

cabinet

Fixing on wood-doors and alu-frames possible.

Art. 150003.200

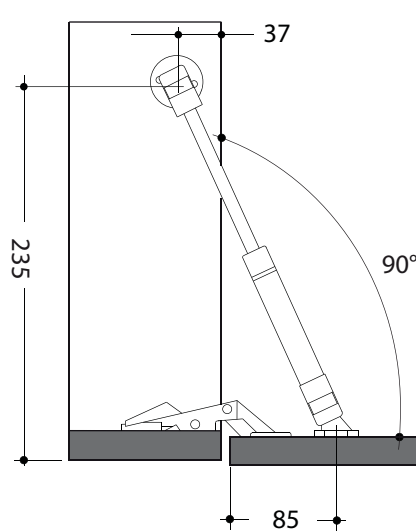
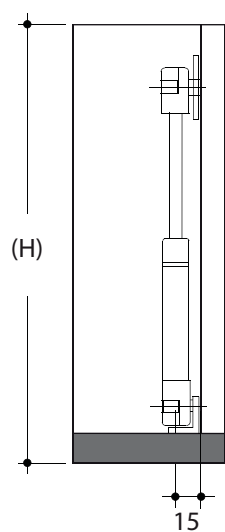
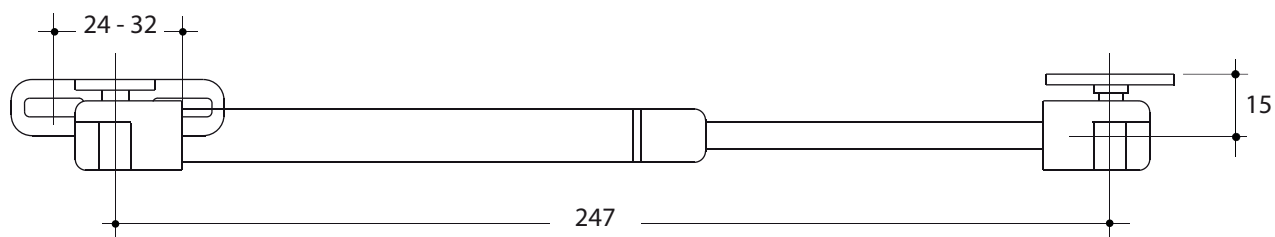

Worktop joints fix*

ZIPBOLT UT
Ø 35 x 20 mm - SW5

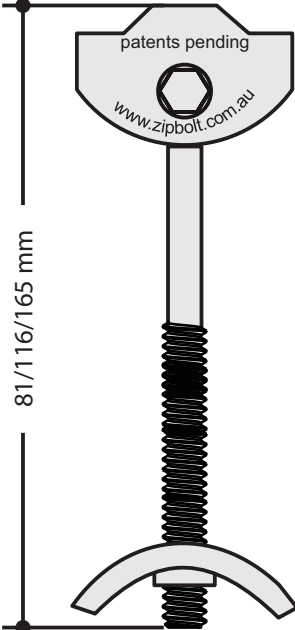

ZIPBOLT UT
Ø 25x 20 mm - SW5

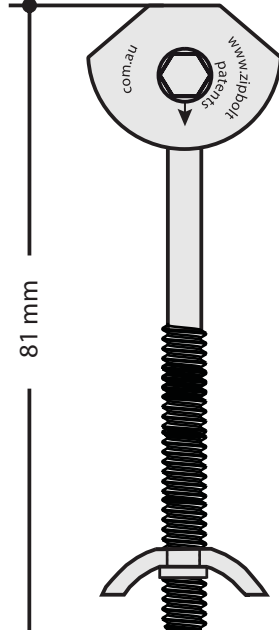

ZIPBOLT MINI UT
Ø 25 x 12,5 mm - SW4

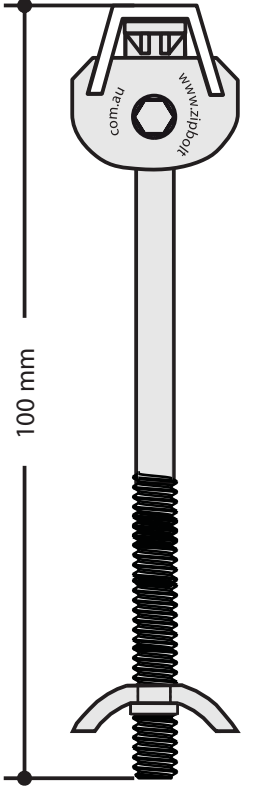

ZIPBOLT DRAWBOLT UT
Ø 20/35 x 12,5 mm - SW4

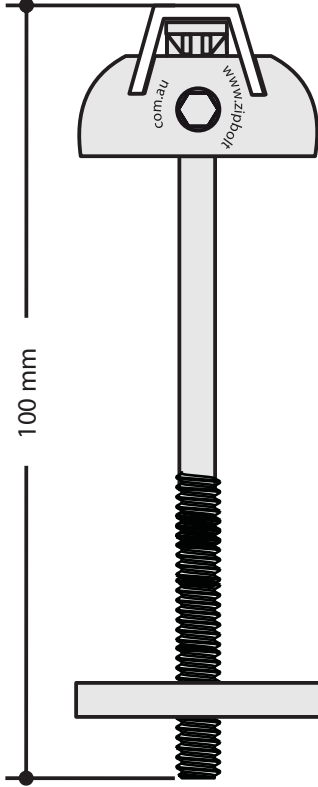

*Bolt can't be separated from housing

Housings loose***



MINI UT - SW4
Ø 25 x 12,5 mm

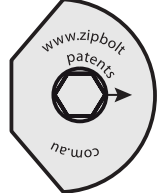

MIDI UT - SW5
Ø 25 x 20 mm

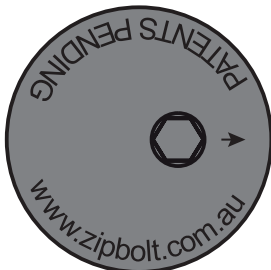

SUPER UT - SW5
Ø 35 x 20 mm

***Can be combined with different bolts/inserts



Bolts for furniture applications

Ø 6,9/ M6 x 30 mm

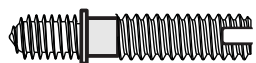

Ø 6,9/M6 x 43 mm



M6 x 90 mm



M8/M6 x 90 mm



Half-mitre 90 - 45° - M6 x 85 mm



Mitre 90 - 180° - Ø6/M6 x 135 mm



Bolts for stair applications

Mitre 90 - 180° - Ø8/M6 x 135 mm



Inserts

M8 x 31 mm



M6 x 21 mm



M6 x 13 mm



Fastening of nevel posts



red dot
2007





UT joint for worktops

New metal housing with the established **ZIPBOLT**-drive, with SW5 Hexagon-drive

- **All metal**
- Fast/solid/easy
- compensates drilling-tolerances
- **Course > 5 mm**
- **Panel-thickness > 22 mm**
- For horizontal assembling

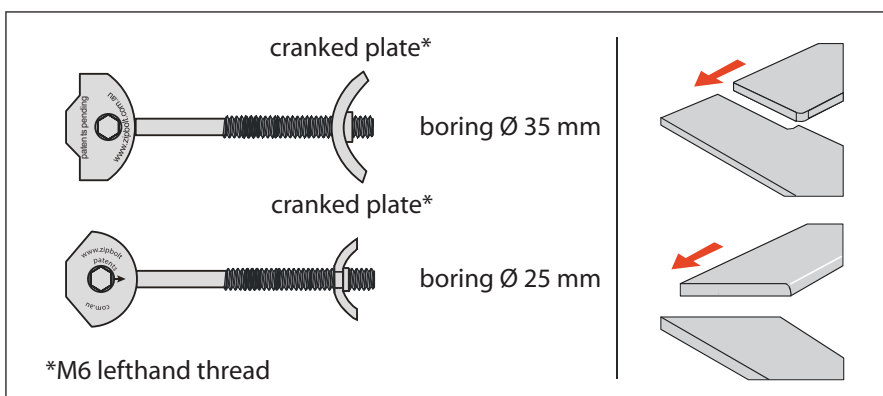

Art. 10.500

Version with cranked plates*, for boring Ø 35 mm

Art. 10.520

Version with cranked plates*, for boring Ø 25 mm

Boring Art. 10.500:

Length 81 mm A = 33 - 44 mm
Length 116 mm A = 48 - 60 mm
Length 165 mm A = 73 - 86 mm



max. 10 Nm

**insert bolts anti-clockwise (lefthand thread), ensuring that fixing can be done clockwise, as usual.*

boring Art. 10.500

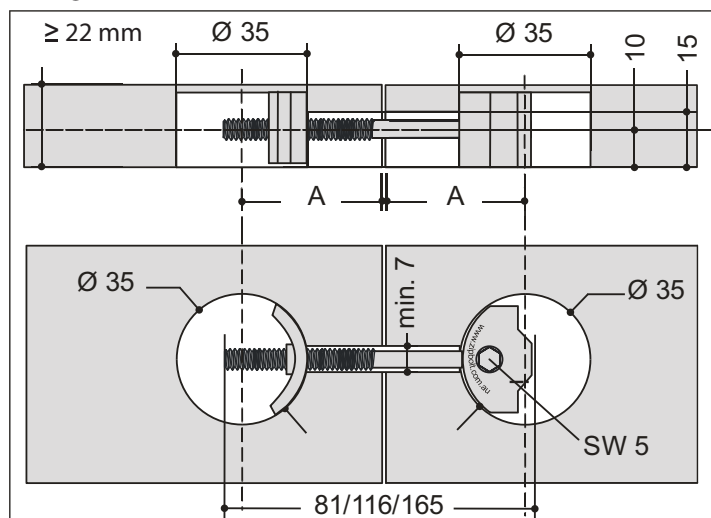

boring Art. 10.520

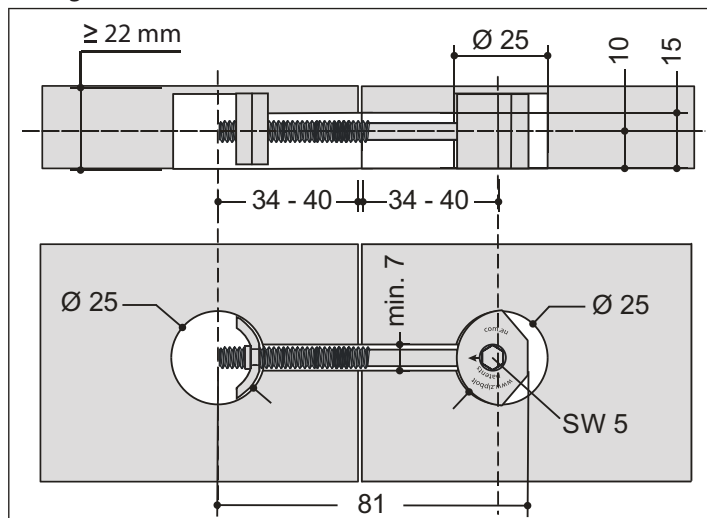



MINI UT TOP 100, joint for worktops

New metal housing with the established **ZIPBOLT**-drive, with SW4 Hexagon-drive

- All metal
- Fast/solid/easy
- compensates drilling-tolerances
- Course >5 mm
- Panel-thickness >14 mm
- For horizontal assembling
- Length 102 mm

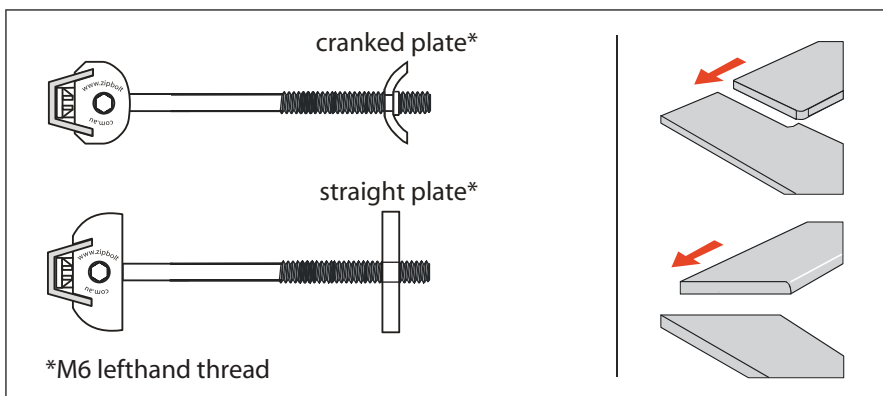

Art. 180005.500

Version with cranked plates,
for boring Ø 25 mm

Art. 180005.600

Version with straight plate
for long hole/slot Ø 20 mm

**insert bolts anti-clockwise (lefthand thread), ensuring that fixing can be done clockwise, as usual.*



max. 10 Nm

boring Art. 180005.500

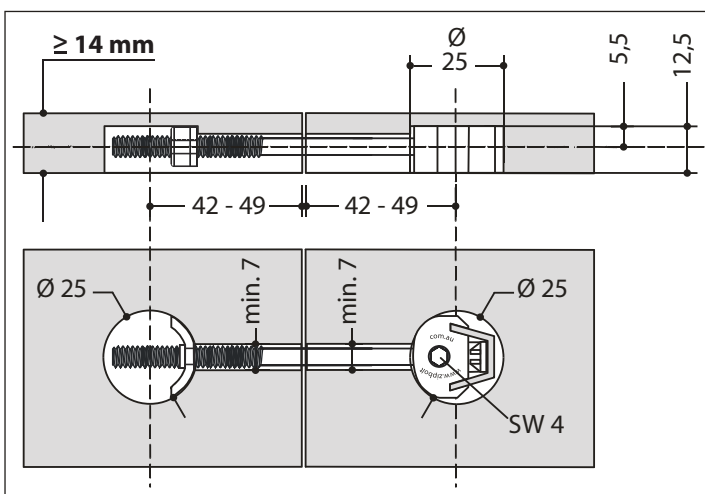

boring 180005.600

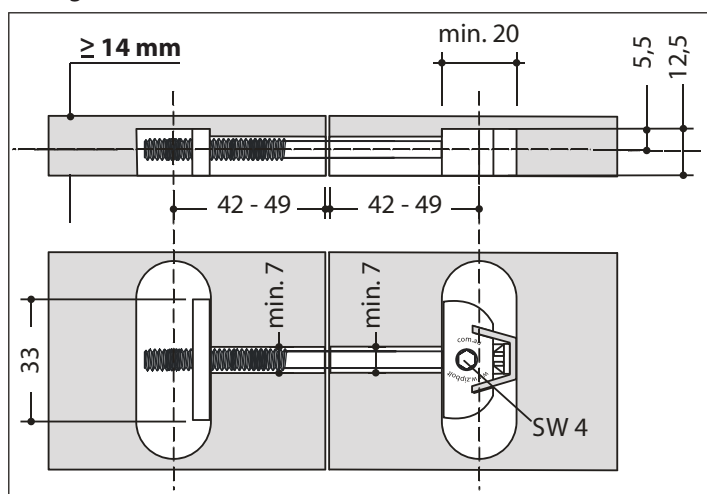



MINI UT INLINE 85, joint for worktops

New metal housing with the established **ZIPBOLT**-drive, with SW4 Hexagon-drive

- All metal
- Fast/solid/easy
- compensates drilling-tolerances
- Course >5 mm
- Panel-thickness >14 mm
- For horizontal assembling

The new modular design allows using this joint in 2 different ways; with 2 bore-holes Ø 25 mm and a groove (min. 7 mm width), common method for joining kitchen worktops.

or

Line-bored with a Ø 7 mm through-hole, see sketch below and illustrations on following pages.

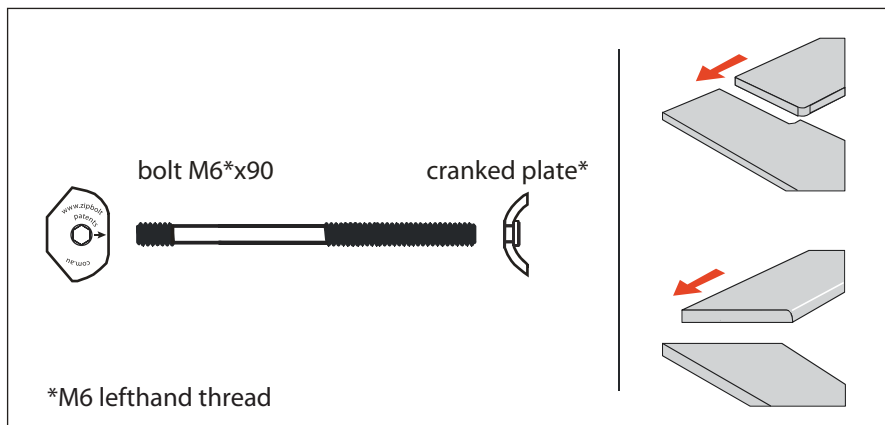

max. 10 Nm

**insert bolts anti-clockwise (lefthand thread), ensuring that fixing can be done clockwise, as usual.*

Please fix and loosen joints alternately and gradually.

boring Art. 10.820

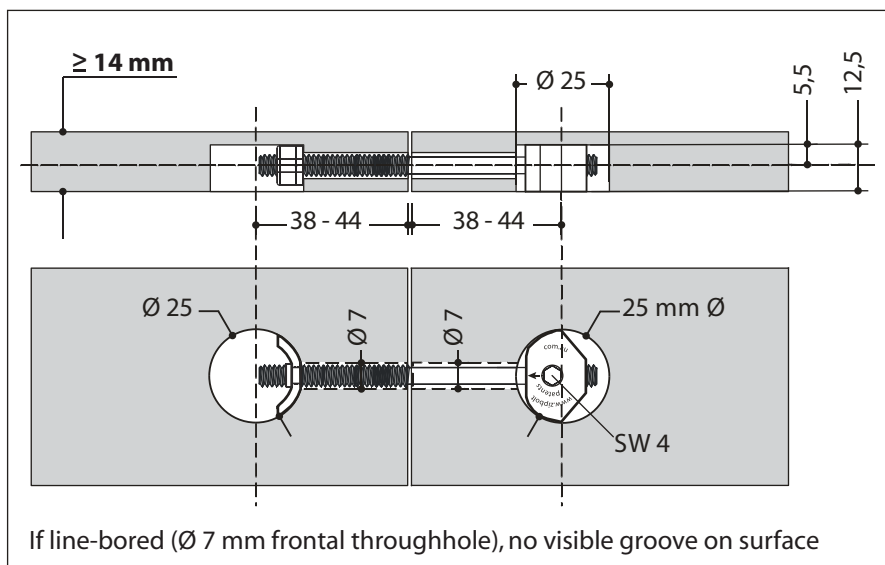

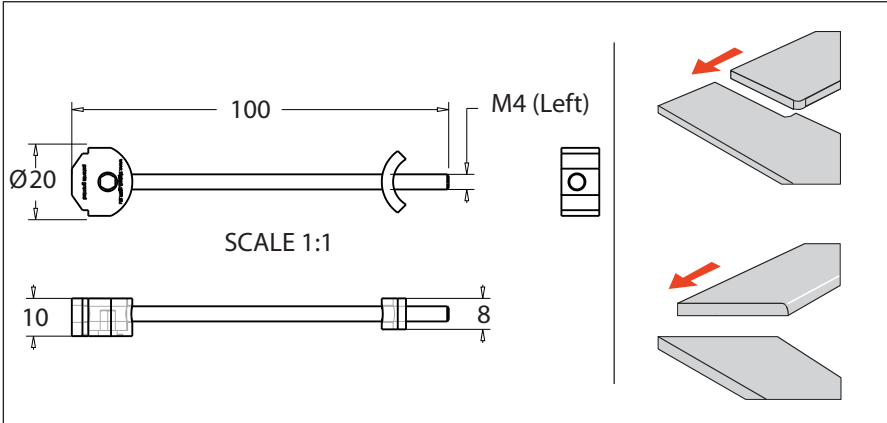

Bohrbild/Foratura/Drilling/Perçage - Art. 18.100

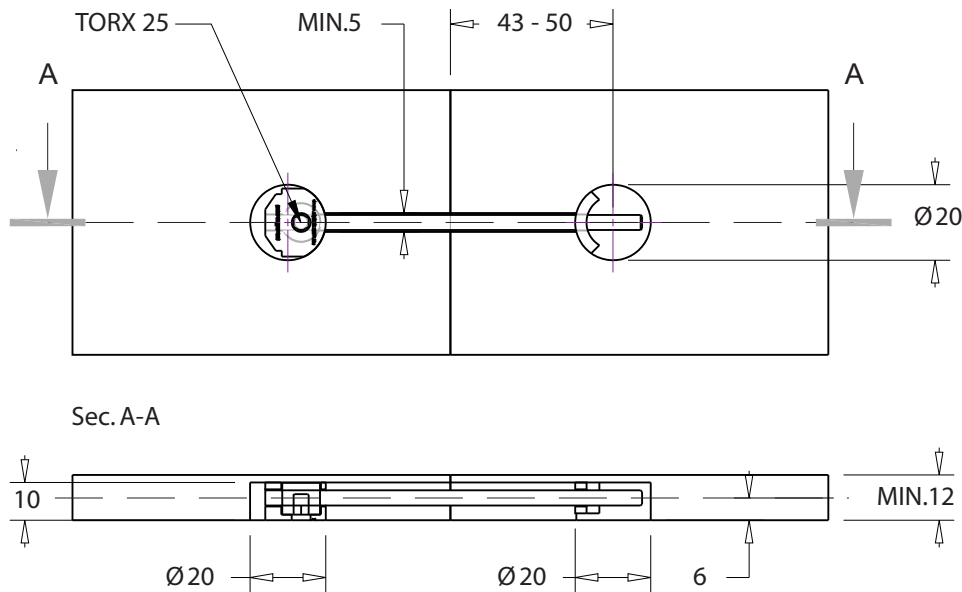

ULTRA SLIM - Art. 18.100

Arbeitsplattenverbinder

Bohrung Ø 20 x 10 mm
Antrieb: TORX 25
L = M4 x 100 mm
Material: Zinkdruckguß/Stahl
Oberfläche: Verzinkt

- Ganzmetallausführung
- Schnell/Robust/Einfach
- Großer Toleranzausgleich
- Spannbereich >5 mm**
- Für dünne Platten ab ca. 12mm
- Horizontale Plattenverbindung

Giunto per piani di lavoro

Foro Ø 20 x 10 mm
Fissaggio: TORX 25
L = M4 x 100 mm
Materiale: Zama/Ferro
Finitura: Zincato

- completamente di metallo
- veloce/solido/semplice
- grande compenso di tolleranze
- Tiraggio >5 mm**
- spessore min. del pannello 12 mm
- assemblaggio orizzontale

Joint for worktops

Drilling Ø 20 x 10 mm
Drive: TORX 25
L = M4 x 100 mm
Material: Zamak/Steel
Finish: Zinc plated

- All metal**
- Fast/solid/easy
- compensates drilling-tolerances
- Course >5 mm**
- Panel-thickness >12 mm
- For horizontal assembling

Assembleur de plan de travail

Perçage Ø 20 x 10 mm
Entraînement: TORX 25
L = M4 x 100 mm
Matière: Zamak/Acier
Finition: zingué

Boîtier métallique

- Rapide / Robuste / Facile
- Compense de grandes tolérances
- Tirage > 5 mm**
- Pour panneaux à partir de 12 mm
- Assemblage horizontal

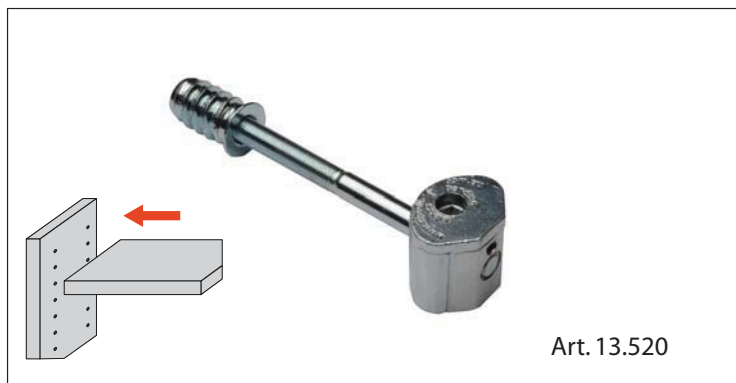

ZIPBOLT MIDI UT KD 6x90, KD-joint

New metal housing with the established **ZIPBOLT**-drive, with SW5 Hexagon-drive

- **All metal**
- Fast/solid/easy
- compensates drilling-tolerances
- **Course > 5 mm**
- For panels-thickness > 22 mm
- For horizontal assembling

Including bolt M6* x 90 mm and insert M6* x 21 mm

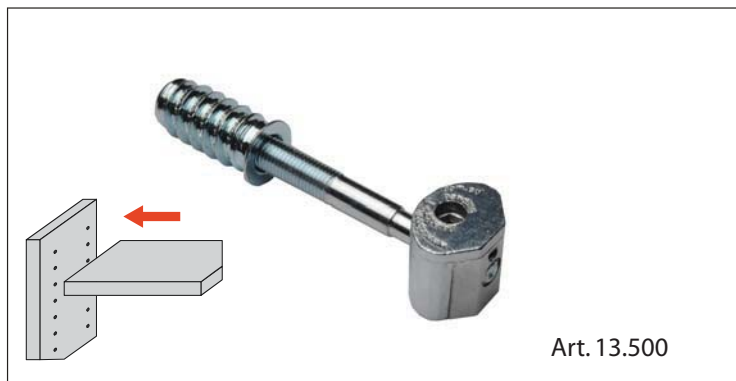

ZIPBOLT MIDI UT KD 8x90, KD-joint

Including bolt M8* x 90 mm and insert M8* x 31 mm

**insert bolts anti-clockwise (lefthand thread), ensuring that fixing can be done clockwise, as usual.*

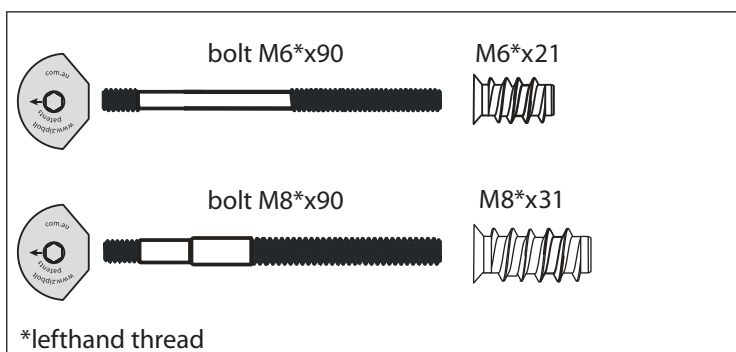

Please fix and loosen joints alternately and gradually.

boring Art. 13.520 M6 x 90 mm

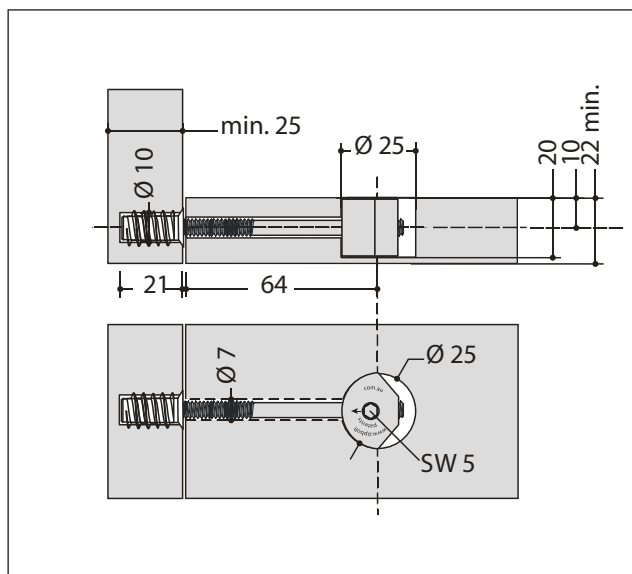

boring Art. 13.500 M8 x 90 mm

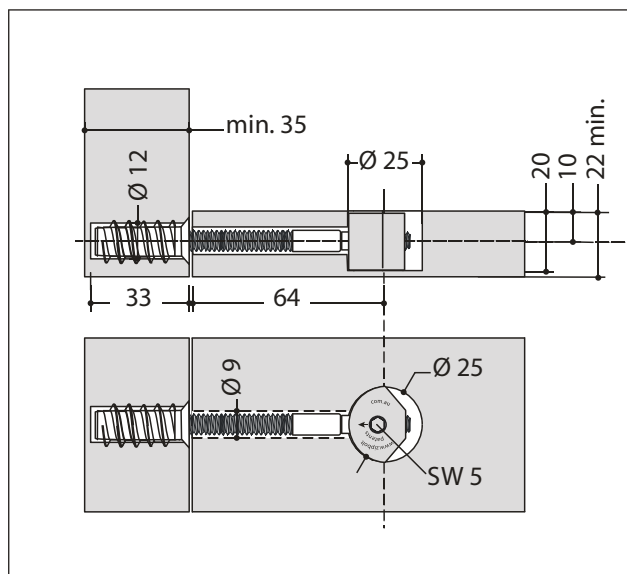



Art. 11.600

MIDI UT 90 - 180°, mitre-joint

New metal housing with the established **ZIPBOLT**-drive, with SW5 Hexagon-drive

- All metal
- Fast/solid/easy
- compensates drilling-tolerances
- Course >5 mm
- Panel-thickness >22 mm
- For angles from 90 - 180°

Including mitre-bolt 90-180°/M6*

**insert bolts anti-clockwise (lefthand thread), ensuring that fixing can be done clockwise, as usual.*

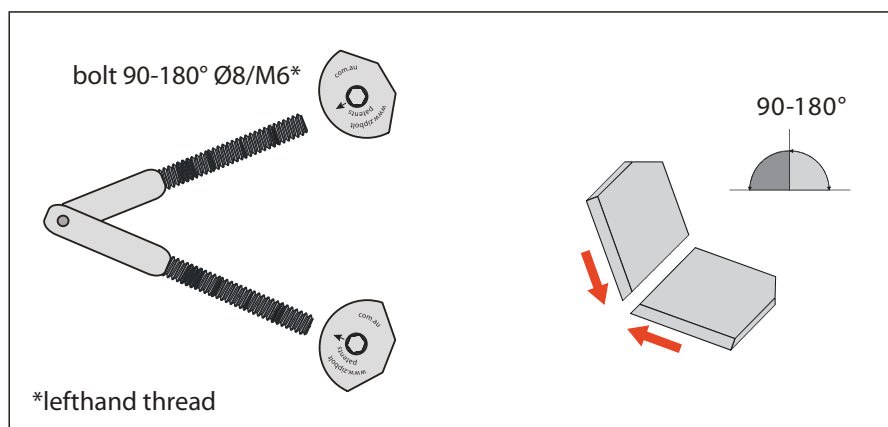

max. 10 Nm



Please fix and loosen joints alternately and gradually.

Drilling Art. 11.600

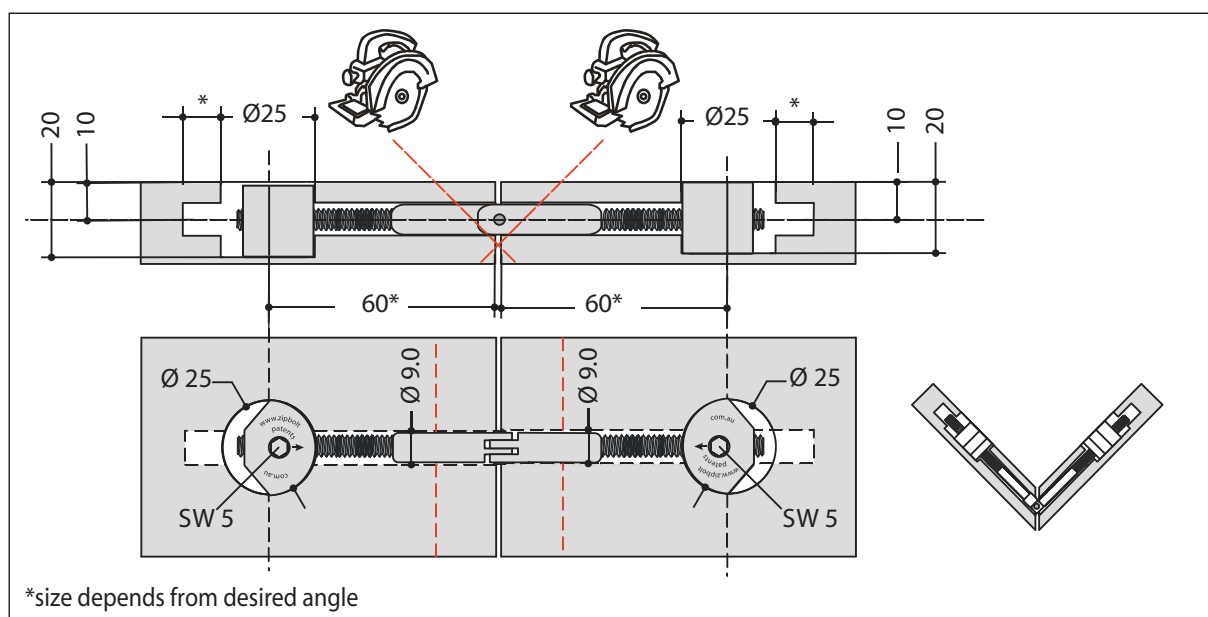

red dot
2007



Working steps horizontal panel-joining with frontal through-hole „INLINE-BORED“

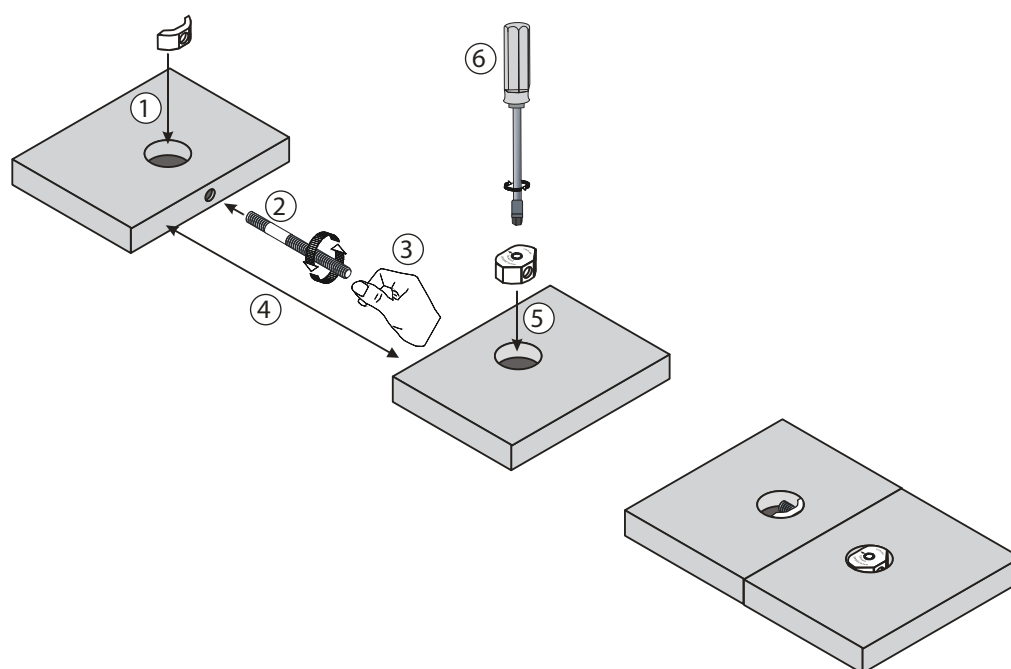

Working steps horizontal panel-joining with visible recess „standard“ e.g. kitchen worktops

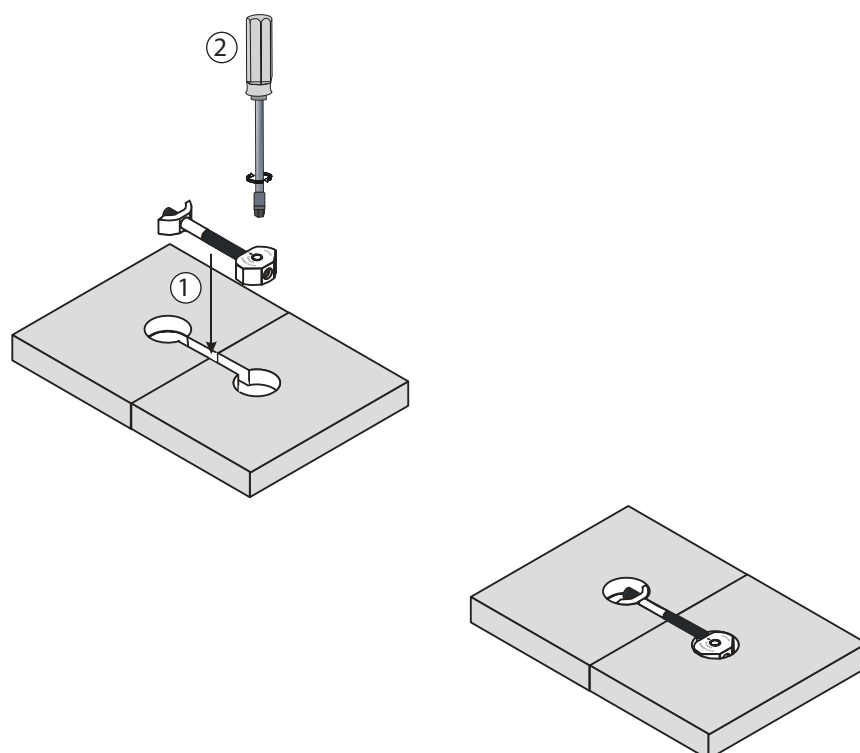

red dot
2007



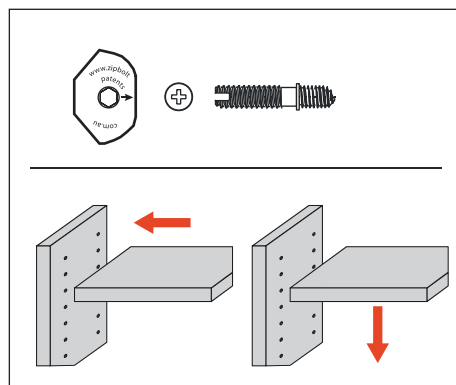

MINI UT KD 6x30, joint for wardrobe cabinets

New metal housing with the established **ZIPBOLT**-drive, with SW4 Hexagon-drive

- All metal
- Fast/solid/easy
- compensates drilling-tolerances
- Course >5 mm
- Panel-thickness >14 mm
- For horizontal or vertical assembling

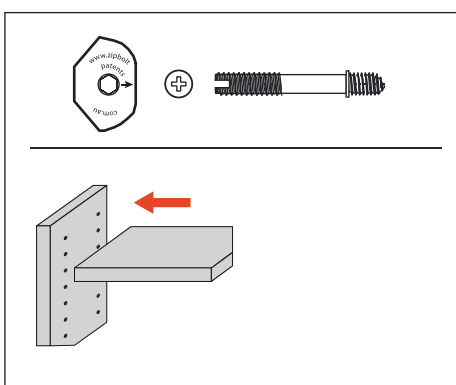

MINI UT KD 6x43, joint for wardrobe cabinets

- For horizontal assembling

Please fix and loosen joints alternately and gradually.



max. 10 Nm

boring Art. 12.601

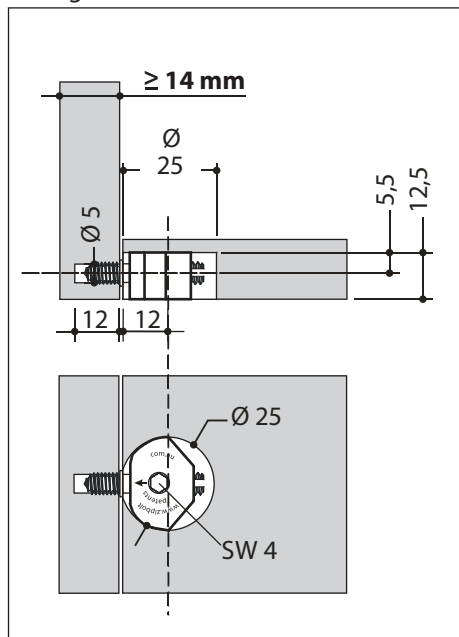

boring Art. 12.600

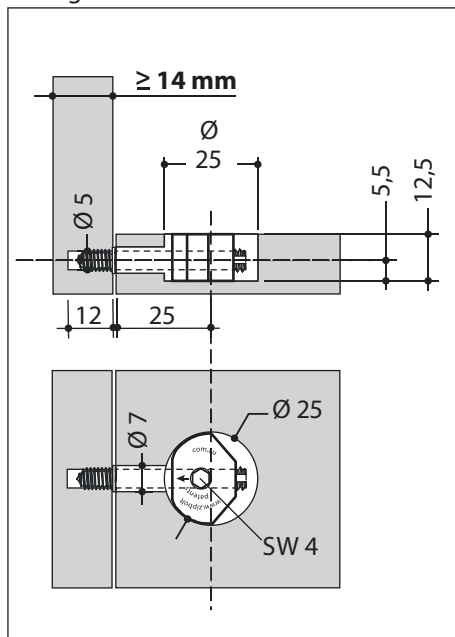

red dot
2007





MINI UT KD 6x90, straight joint

New metal housing with the established **ZIPBOLT**-drive, with SW4 Hexagon-drive

- All metal
 - Fast/solid/easy
 - compensates drilling-tolerances
 - Course >5 mm
 - Panel-thickness >14 mm
 - For horizontal assembling
- including bolt M6* x 90 mm
and insert M6* x 13 mm



MINI UT KD 8x90, straight joint

For heavy constructions, such as tables, beds, exhibition-stands

including bolt M8* x 90 mm
and insert M8* x 31 mm

**insert bolts anti-clockwise (lefthand thread), ensuring that fixing can be done clockwise, as usual.*

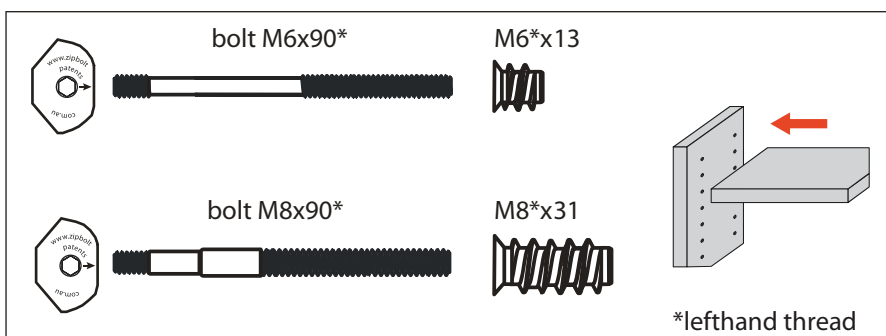

Please fix and loosen joints alternately and gradually.

boring Art. 12.720 M6 x 90 mm

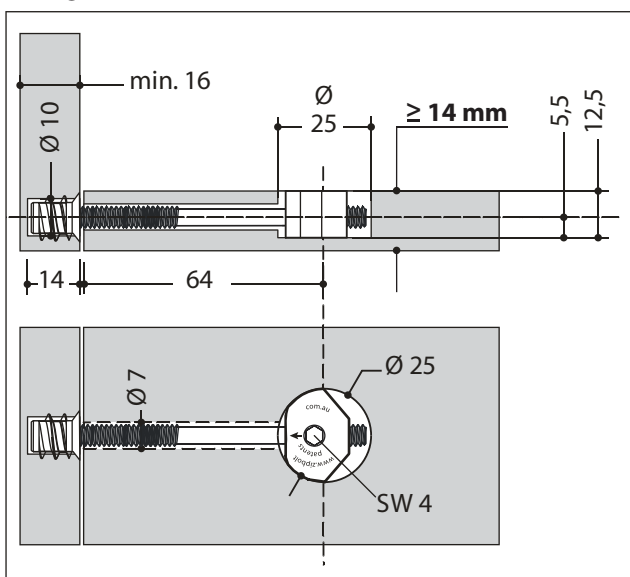

boring Art. 12.700 M8 x 90 mm

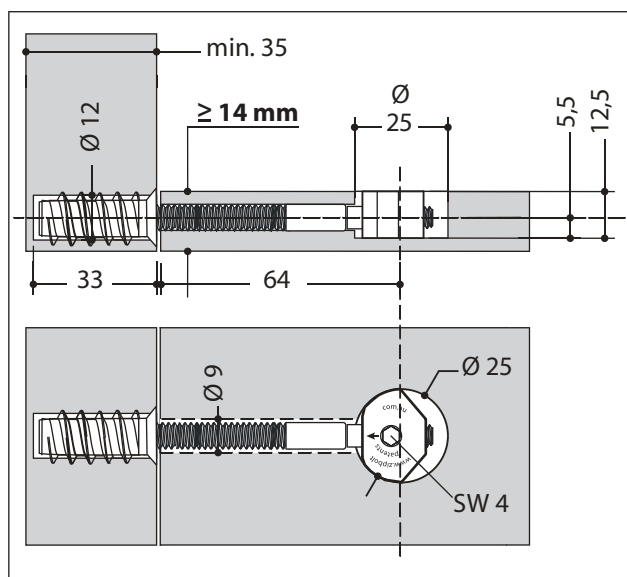



MINI UT KD 90-45°, half-mitre joint

New metal housing with the established **ZIPBOLT**-drive, with SW4 Hexagon-drive

- All metal
- Fast/solid/easy
- compensates drilling-tolerances
- Course >5 mm
- Panel-thickness >14 mm
- For angles from 90 - 45°

Including mitre-bolt 90 - 45°/M6* and insert M6* x 13 mm

**insert bolts anti-clockwise (lefthand thread), ensuring that fixing can be done clockwise, as usual.*

Please fix and loosen joints alternately and gradually.

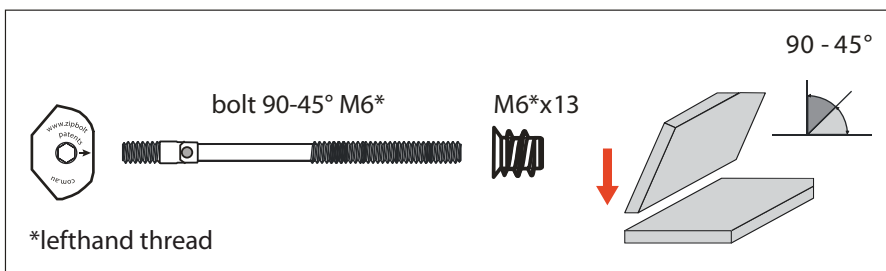

boring Art. 11.720

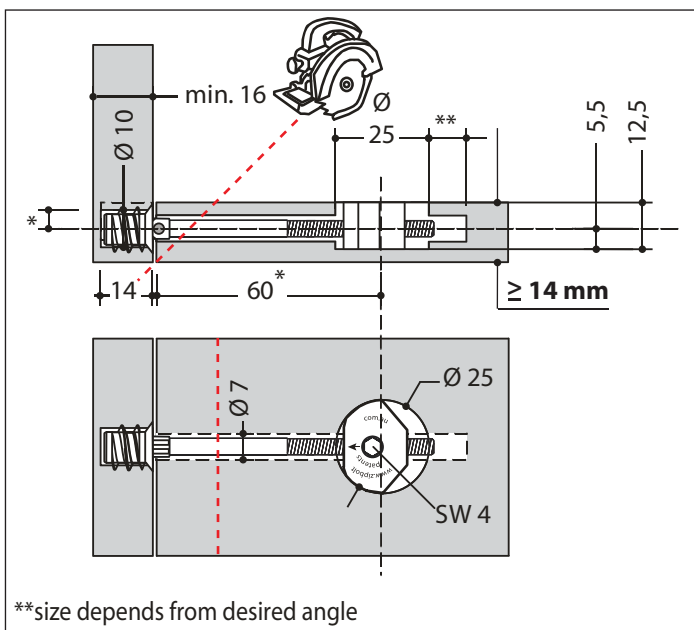

max. 10 Nm

*Adapting axle-distance acc. to desired angle; e.g. 45°

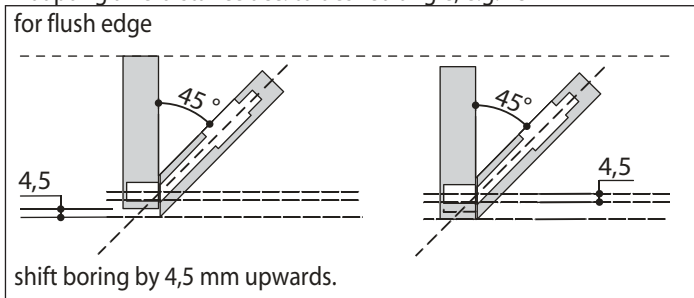



Art. 11.700

MINI UT 90 - 180°, mitre-joint

New metal housing with the established **ZIPBOLT**-drive, with SW4 Hexagon-drive

- All metal
- Fast/solid/easy
- compensates drilling-tolerances
- Course >5 mm
- Panel-thickness >14 mm
- For angles from 90 - 180°

Including mitre-bolt 90 - 180°/M6*

**insert bolts anti-clockwise (lefthand thread), ensuring that fixing can be done clockwise, as usual.*

bolt 90-180° M6*

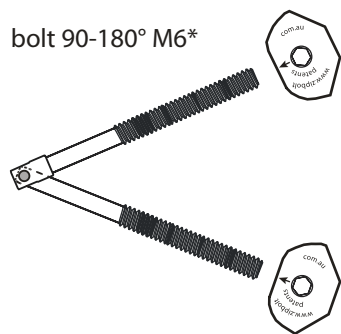

*lefthand thread

90-180°

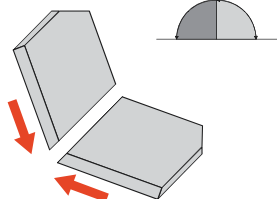

Drive



Hex. SW4



max. 10 Nm



Please fix and loosen joints alternately and gradually.

boring Art. 11.700

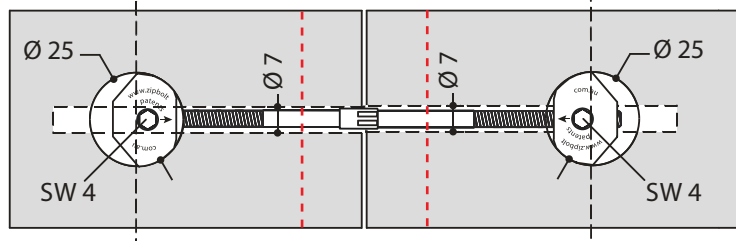
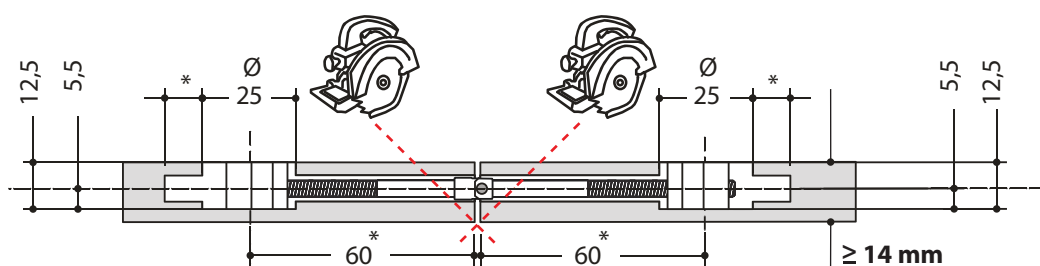

*size depends from desired angle



reddot
2007





MIDI UT Railbolt , connector e.g. for handrails/staircases

New metal housing with the established **ZIPBOLT**-drive, with SW5 Hexagon-drive

- **All metal**
- Fast/solid/easy
- compensates drilling-tolerances
- **Course > 5 mm**
- For horizontal assembling

Including bolt M6* x 98 mm

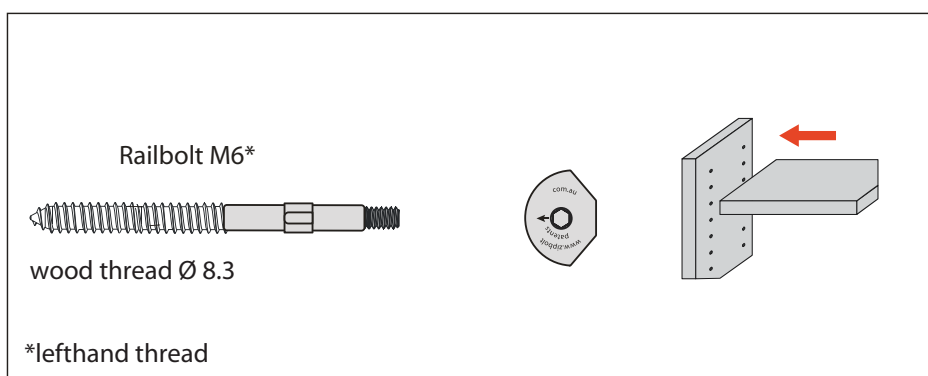

max. 10 Nm

Joining of handrail/stair

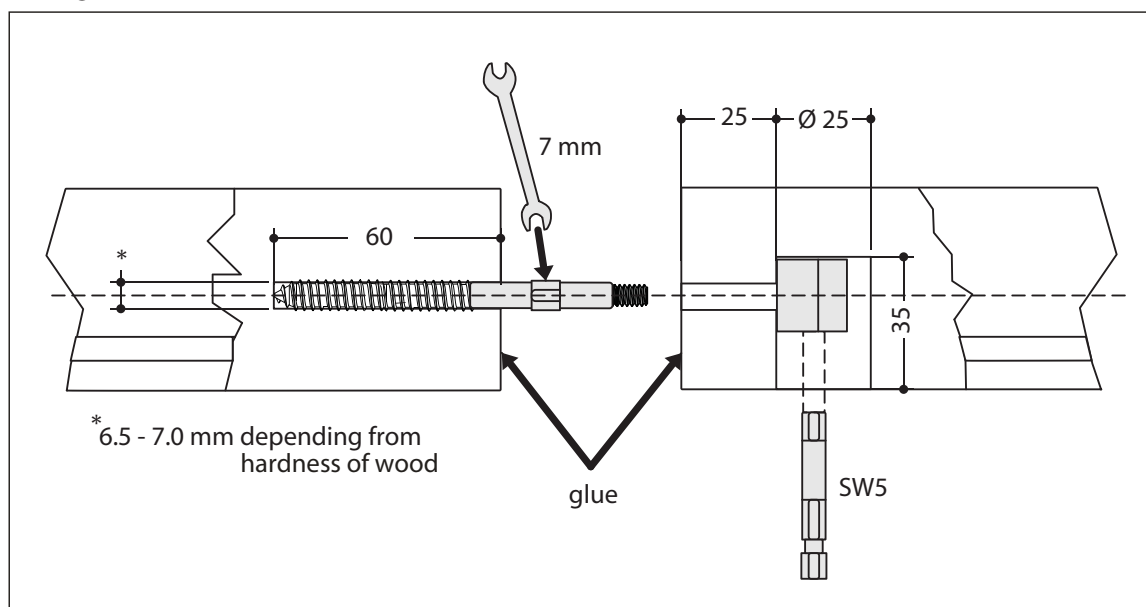

reddot
2007





Art. 11.550

MIDI UT Angled Railbolt 90-45°

The UT Angled Railbolt, primarily designed for the stair industry to solve the problem of secretly attaching the hand rail at an angle to a newel post.

The connector uses the UT drive technology which enables easy tightening at a right angle and deep within the hand rail just using a hex bit or simple Allen key.

The pivoting 8mm shaft has a coach bolt thread (wood thread) which can be simply hand wound into the post and once the hand rail has been bored and the angle cut (last) it is easily attached. The pivoting action caters to any necessary angle open or closed, it produces a strong joint without the unsightly long screw going through the visible face of the newel post or ugly filled nail holes.

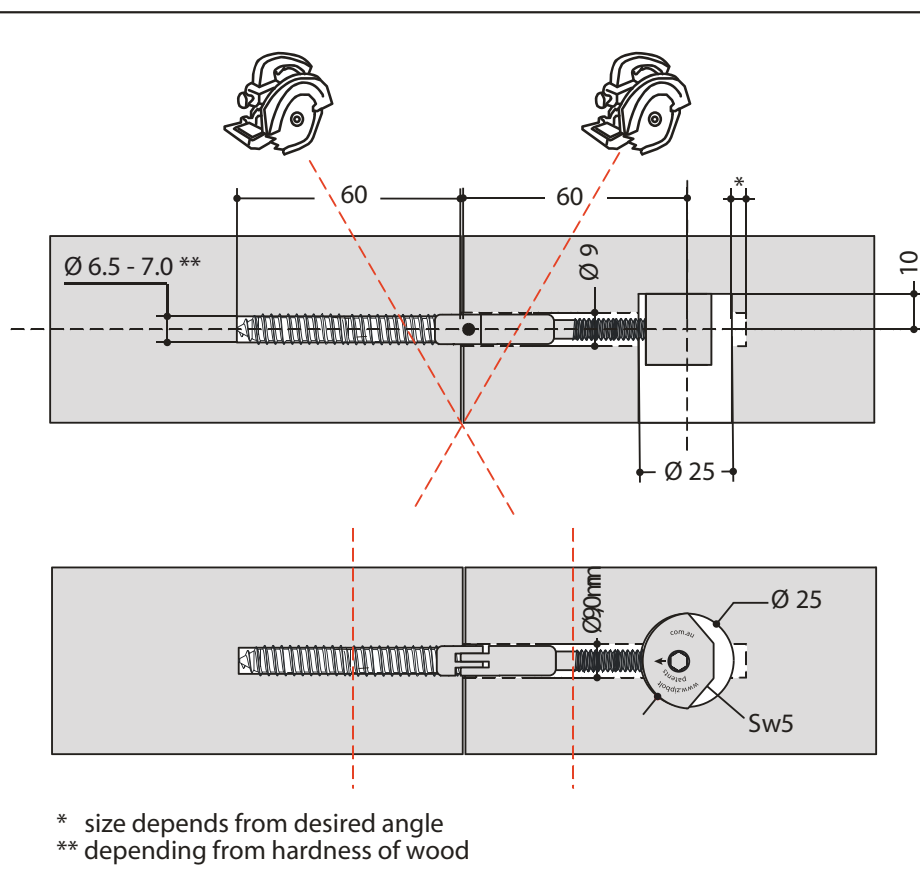
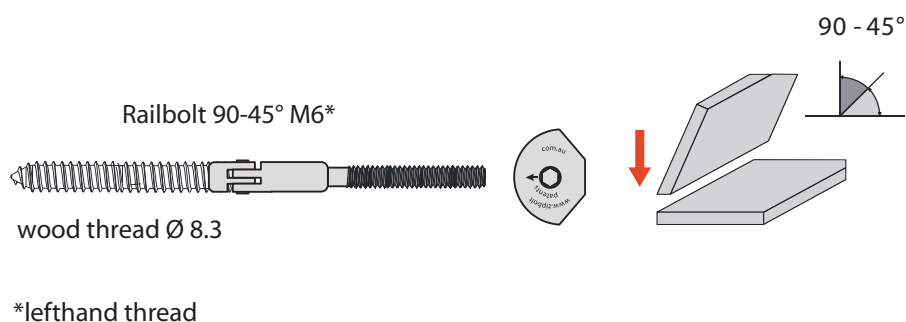

reddot
2007



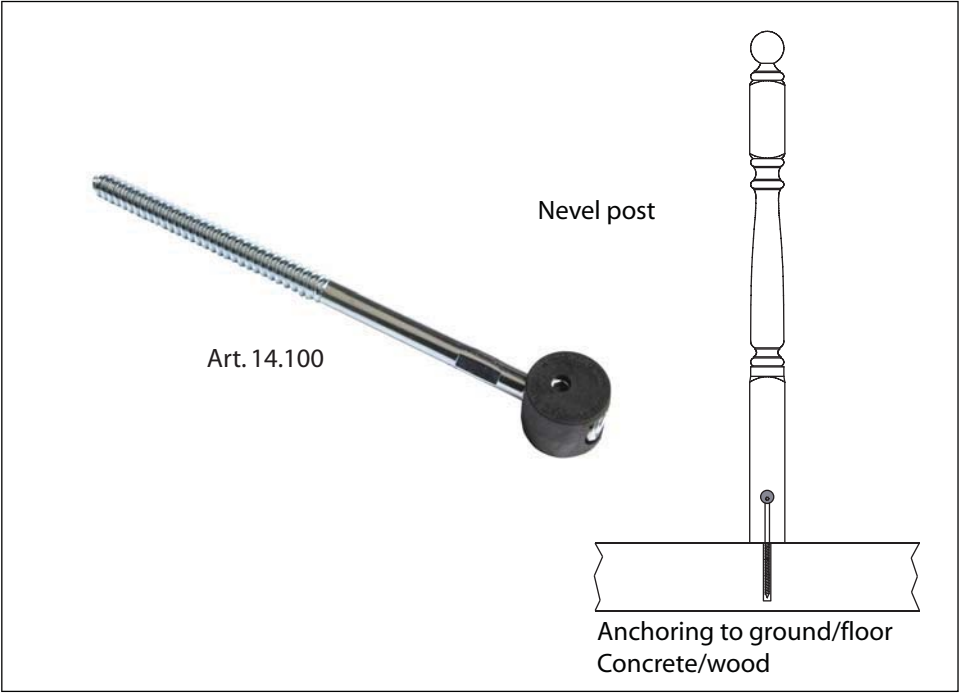

max. 10 Nm

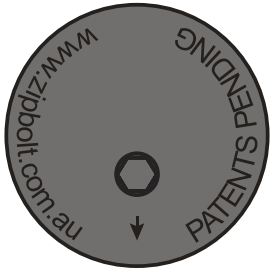

Scale 1:1

Ø 13.5 x 275 mm

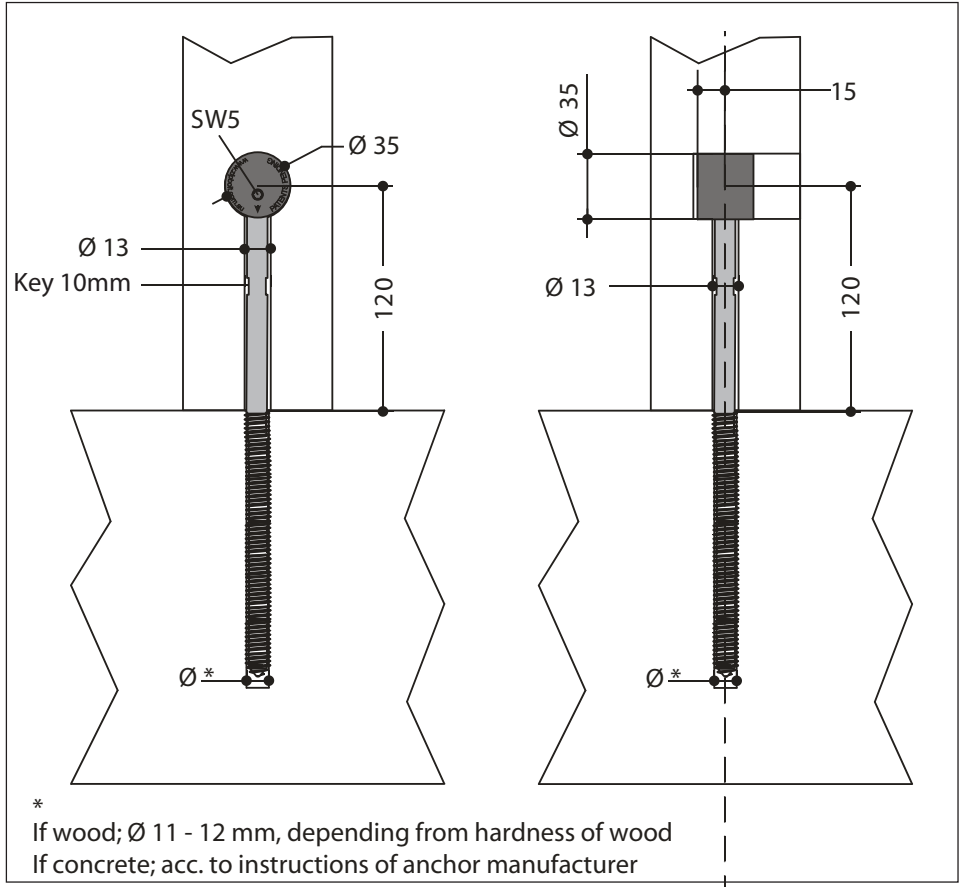



Kitchen worktops



Furniture/living



Tables



Beds



Beds/Headrests



Windows/doors/frames



Exhibition stands



Shop furnishings/projects



Stairs/posts/handrails



Handrail joining



reddot
2007





Art. 15.100

The **ZIPBOLT FASTFIT™** is truly a one piece - one step connector, this new generation of knockdown connector continues to incorporate Zipbolts' Patented gear drive technology to achieve a new approach to furniture/cabinet assembly. It is released coinciding with the world wide trend towards the use of CNC Routers or Nesting machines and the result is fast and easy manufacturing saving time and money.

FASTFIT uses a unique mechanism to conceal the thread within the dowel section and then using the gear drive exits the thread to bite directly into the wall of the hole producing a very strong anchor.

It is designed to be unlocked more than once if the situation arises that you need to re adjust or re assemble a cabinet.

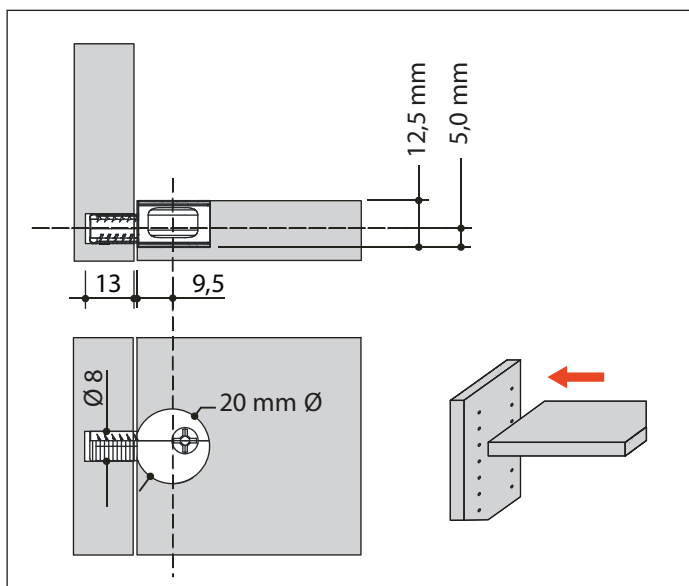

Lock/Unlock with a 180° screwdriver-turn
Philips-cross

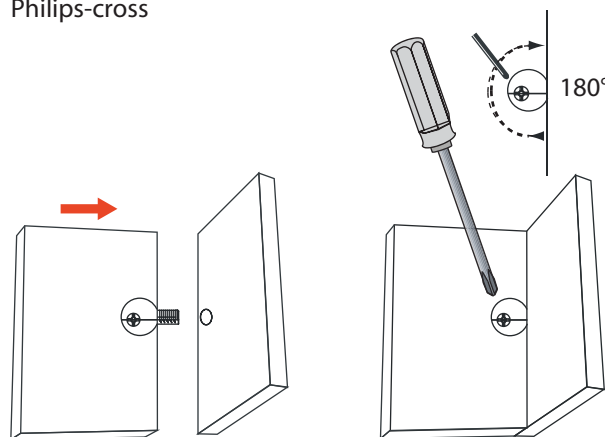

The FASTFIT can be installed upside down, e.g. for panels with thickness >16 mm; additional Ø 8 mm throughhole needed (*).

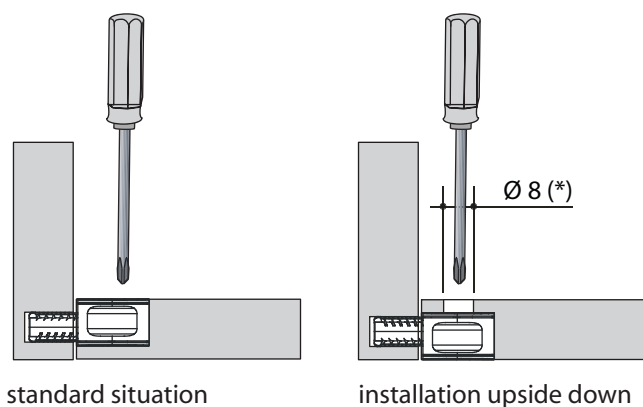

with upside down installation, joint is not visible inside the cabinet, just the Ø 8 mm hole is visible

(*) eccentric hole

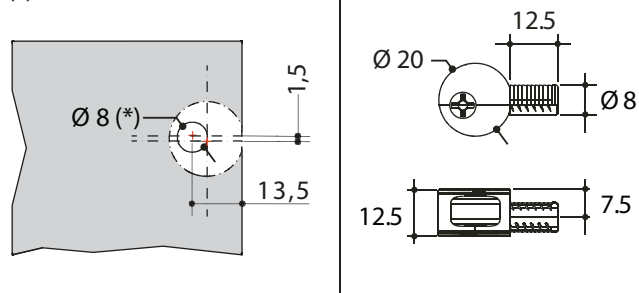

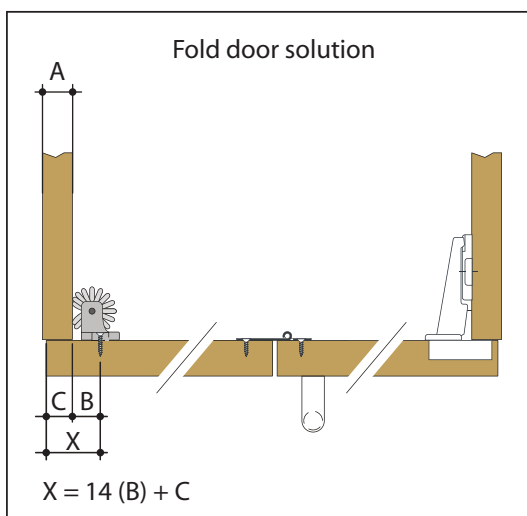
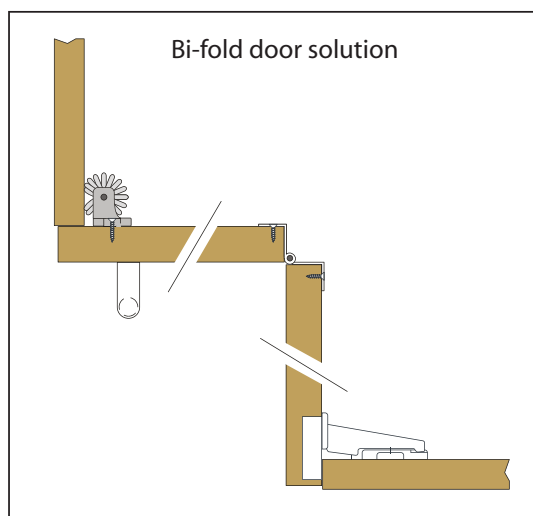
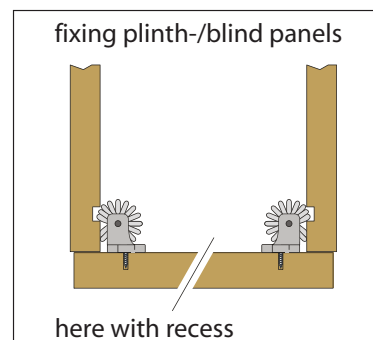
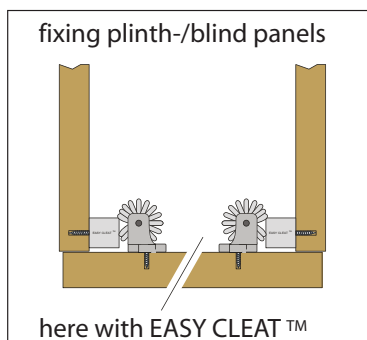
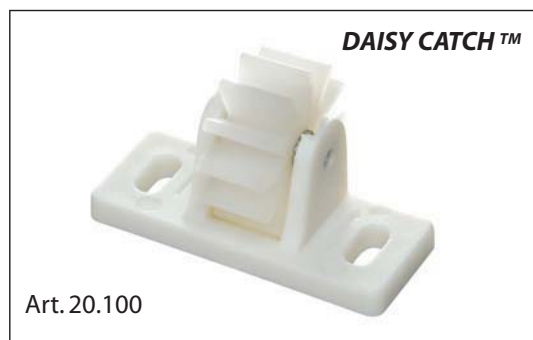

p
a
t
e
n
t
s

p
e
n
d
i
n
g

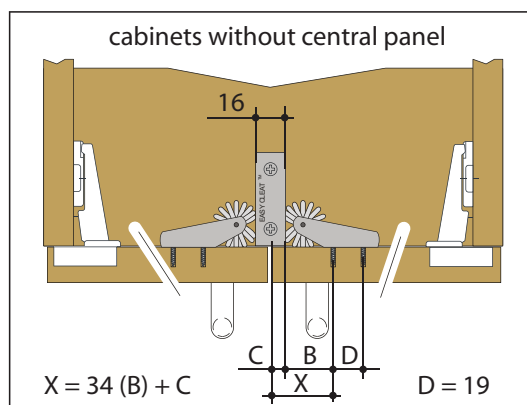

Product videos on:
www.ahb-beschlaege.de

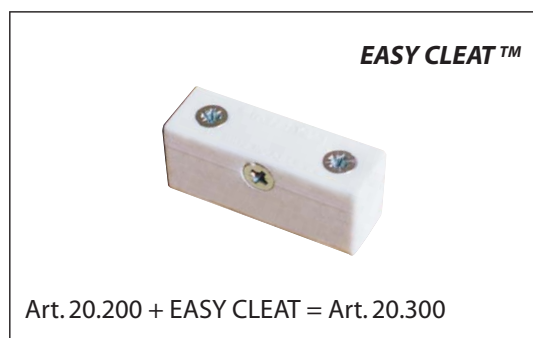

DAISY CATCH

has been designed for quick easy fitting, while protecting adjacent door and maintaining door gap in many applications. The revolutionary wheel design in resilient material avoids use of additional components inside the cabinet. One part and you are done.

DAISY CATCH-INLINE in combination with EASY CLEAT,

- Fixing down bench tops - Fixing panels
- Mounting fixed shelves
- Reinforcement - Use your imagination

Colours: white/brown/black

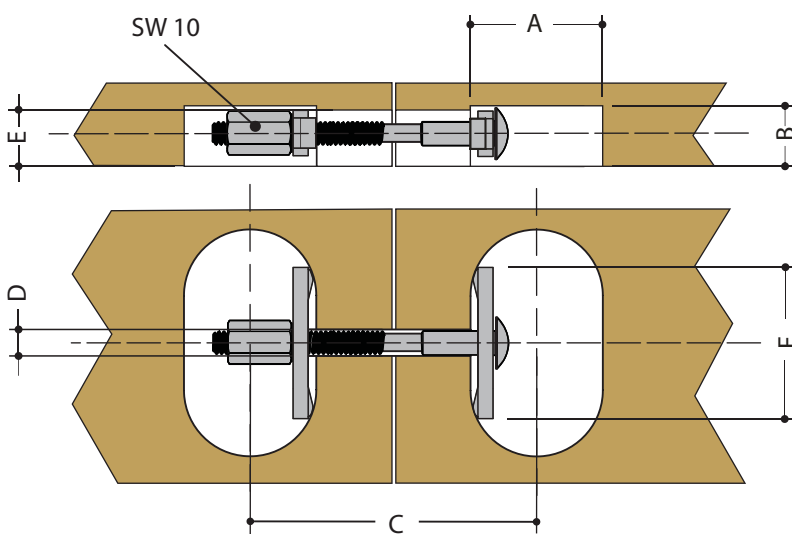
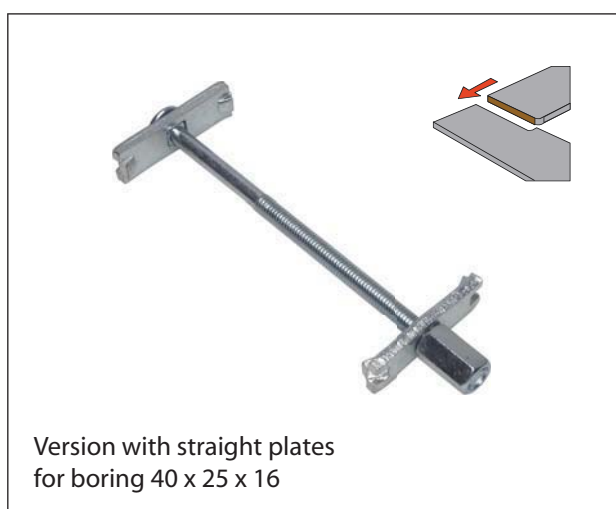
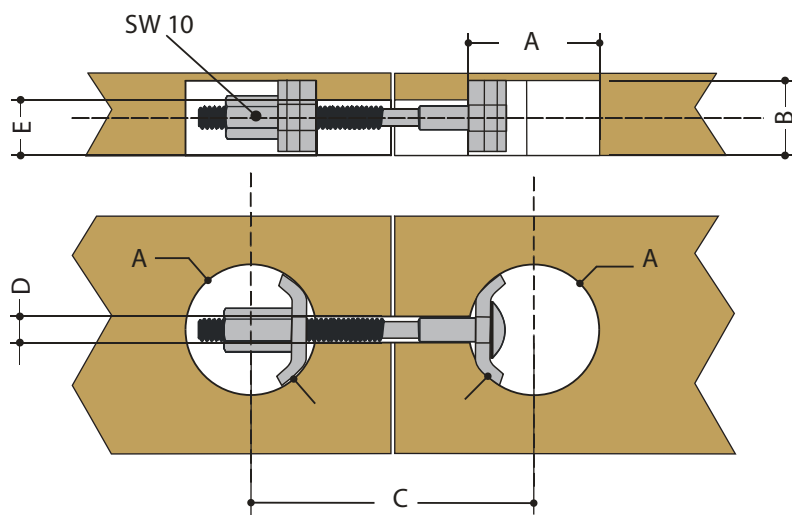
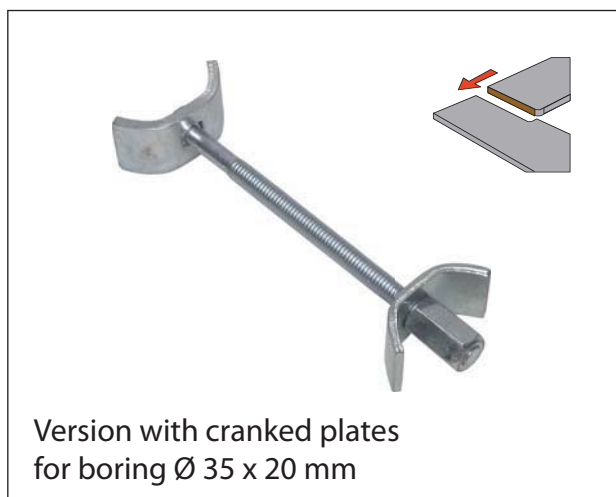

A	B	C	D	E	F	Art.
$\varnothing 35$	20	65	min. 7	15 - 20	-	180004.829.02
$\varnothing 35$	20	100	min. 7	15 - 20	-	180004.829.06
$\varnothing 35$	20	150	min. 7	15 - 20	-	180004.829.01
min. 25	16	65	min. 7	12 - 16	min. 40	180004.829.26
min. 25	16	100	min. 7	12 - 16	min. 40	180004.829.31
min. 25	16	150	min. 7	12 - 16	min. 40	180004.829.35

Available installation supports (optional)*

special length/OEM solutions on demand

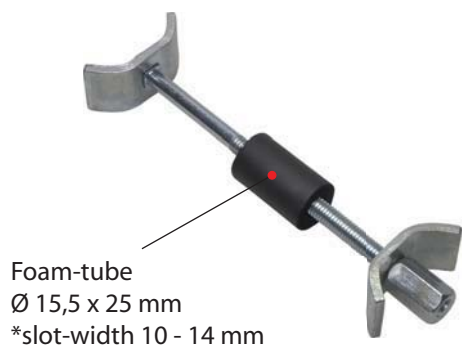



Wardrobe-Lift **LIFT 10**,

Aluminium-execution, tubes made of anodized aluminium with rip-design, plastic-parts silver lacquered, with oil-damping-system for soft lowering of clothes and for support during lifting of clothes into the cabinet.

Fixing directly onto the side-panels inside the cabinet.
Allows the comfortable use of inner-space which normally can be only hardly reached.

Loading-capacity max. 10 kgs.

Packing: 870 x 180 x 100 mm
Unit: 6 Set per box
Weight: 2,9 kg per set

Standard sizes			
Size 1	Size 2	Size 3	Size 4
450 – 600	600 – 830	720 – 980	830 – 1150
Art.	Art.	Art.	Art.
LIM450600	LIM600830	LIM720980	LIM 8301150
Colour-/Material-combinations			
ALU/plastic	silver/silver	silver/black	
steel/plastic	chrome/silver	chrome/black	

Colour-/Material-combinations

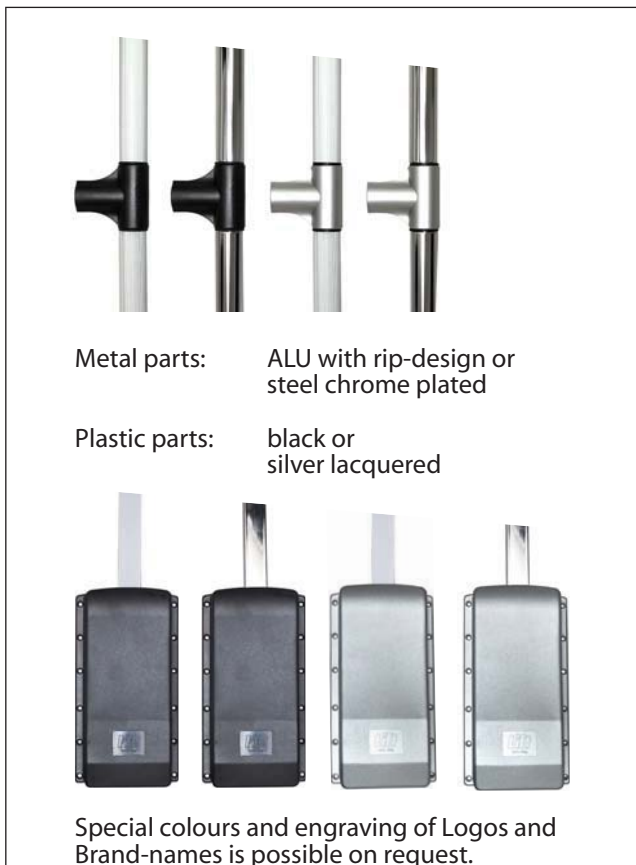

Accessories:

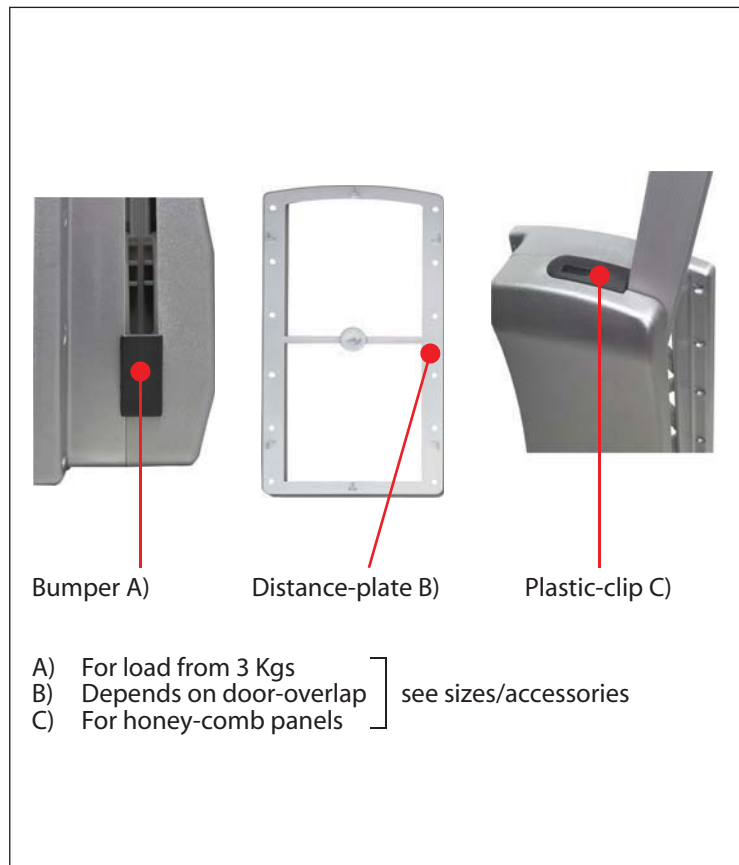

LIFT 10 - SIZES AND ACCESSORIES

Required space

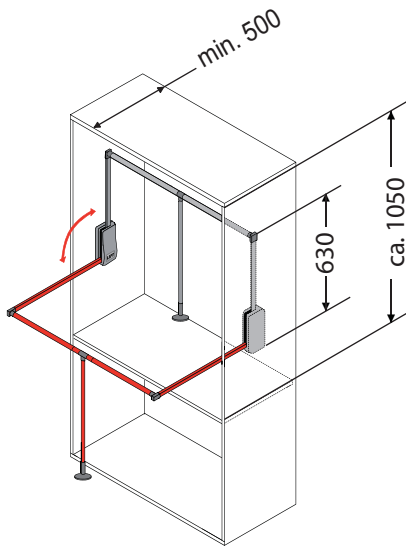

Distance-plates (optional)

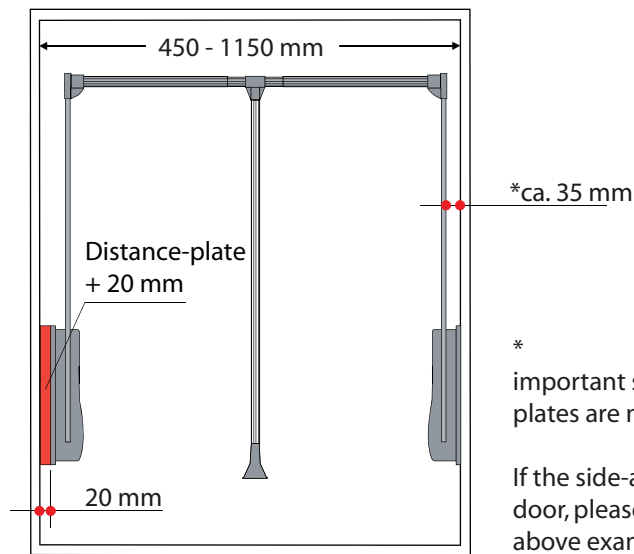

Art. PLM4501150.001 (SW)
Art. PLM4501150.501 (SIL)



*
important size for determination if distance-plates are needed.

If the side-arms may touch the hinges of the door, please use the distance-plates, see above example

Mounting of bumper (included in standard-packing)

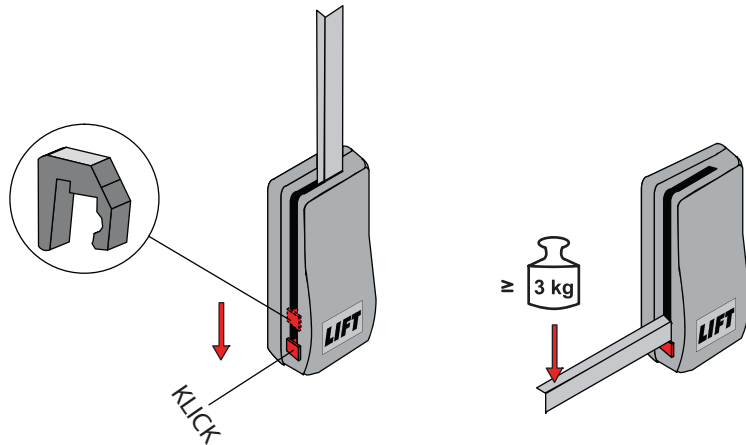

Bumper,
Suggested for loads exceeding 3 Kgs

Limitation of course (optional)

(for honey-comp panels with solid timber-frame)

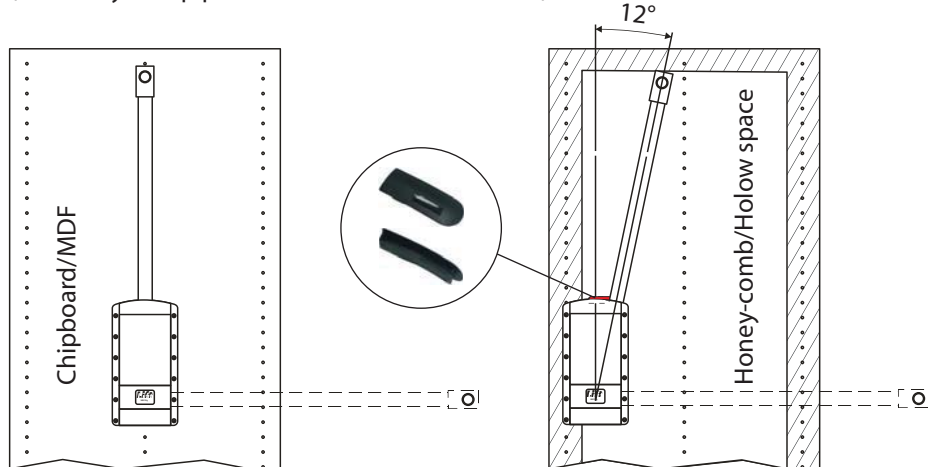

Not necessary with chipboard/solid wood. Fixing on centre of panel.

Limitation with plastic-clip.
LIFT can be shifted backwards and fixed onto the solid frame.

Art. STSTOPPER.001





Wardrobe-Lift **LIFT ALU 15**,

The **LIFT ALU 15** differs from the basic model LIFT ALU 10, due to 5 kgs more loading-capacity and a unique mounting-system, with considerable ease of use.

Instead of fixing the complete Lift-arm to the side-panel this model allows to position and fix first a small ground-plate, which can be used also as spacer*.

Then the Lift-arm can be easily placed onto the ground-plate and fixed to the side-panel. The last step is the application of a decorative plastic-cover which gives the elegant design to the **LIFT ALU 15**.

With oil-damping-system for soft lowering of clothes and for support during lifting of clothes into the cabinet.

Loading-capacity max. 15 kgs

*

The **LIFT ALU 15** can be completed with a number of accessories, see catalogue-page „Accessories **LIFT ALU 15**“.



Silver/Silver



Black/Silver

Material: Aluminium/Plastic

Standard colours: Silver/Silver -
Black/Silver

Standard sizes: N.1 450 - 600 mm
N.2 600 - 830 mm
N.3 830 - 1150 mm

Packing: 885 x 140 x 130 mm

Unit: One piece per carton
46 pcs. in PAL-BOX 120 x 80 cm

Weight: 4,3 kgs pro Set



Base-plate/Distance-plate



with Distance-plate

LIFT-Arms can be used right/left

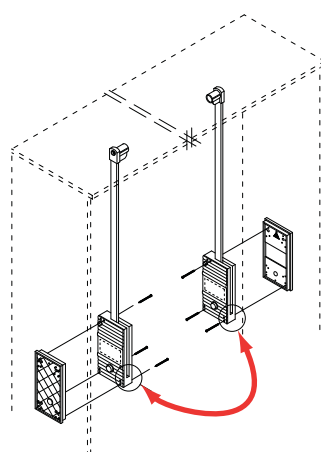

New type of mounting-system

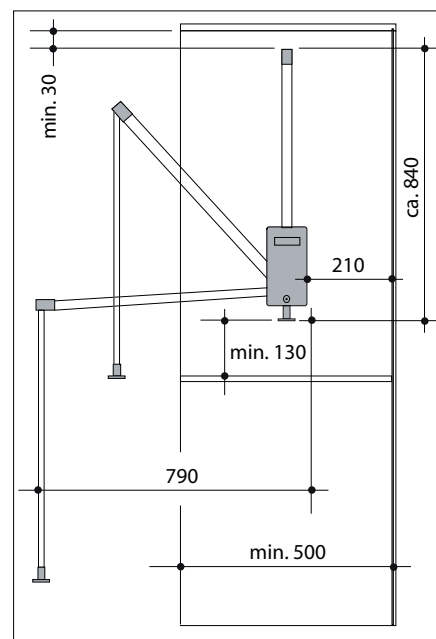

Required space/side view

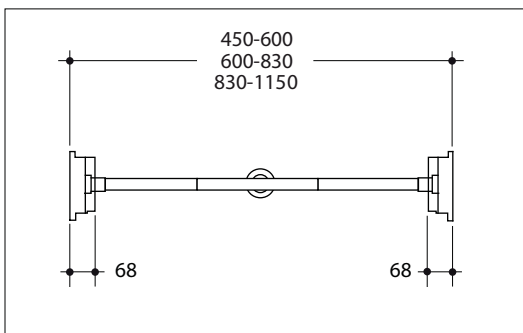

View on top

1. DISTANCE-PLATE/SPACER Art. PLE4501150.501

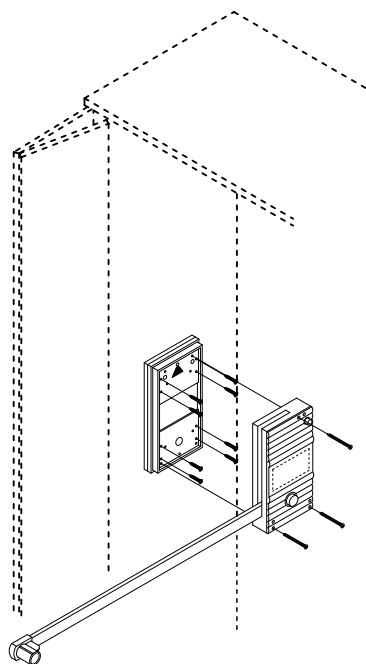

Mounting without distance-plate
(illustration without plastic-cover)

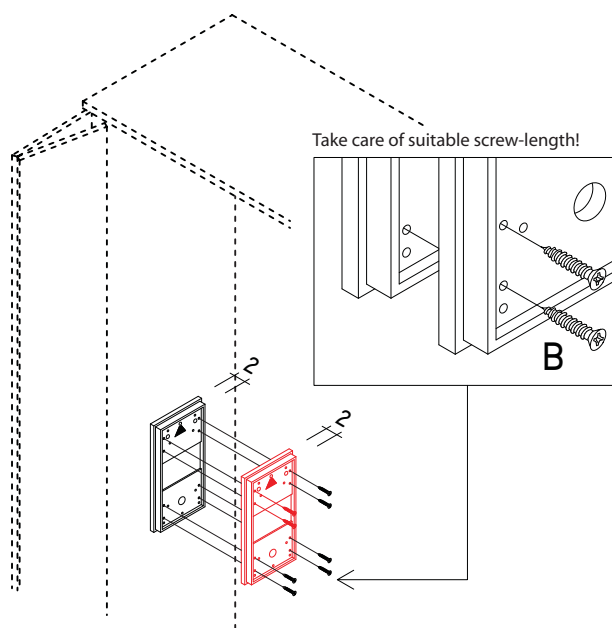

Mounting with additional distance-plate,
avoids contact with overlapping door

2. ADAPTER FOR HONEY-COMB PANELS

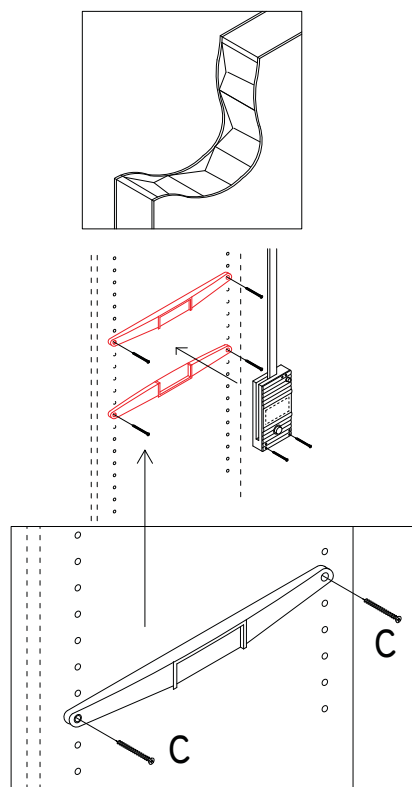

3. ADAPTER FOR WALL-FIXING*

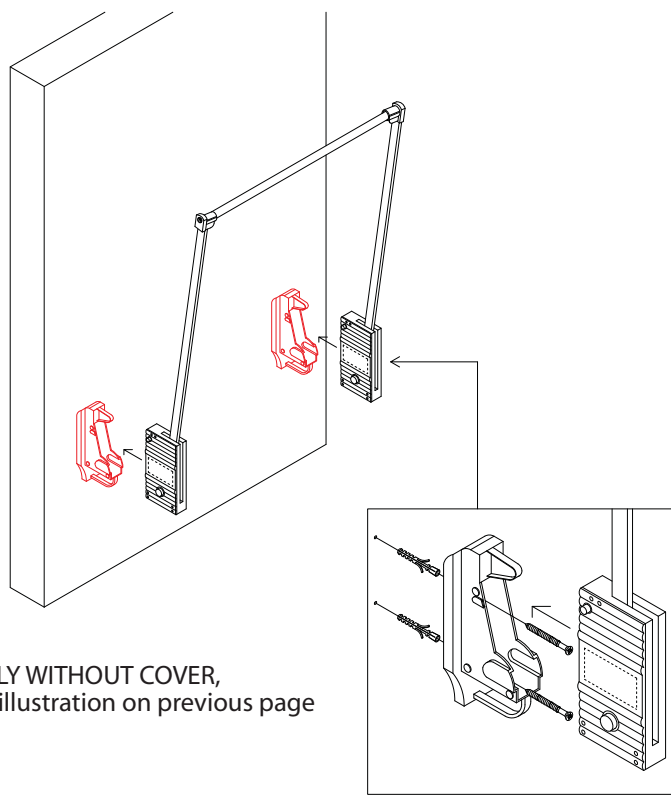

*ONLY WITHOUT COVER,
see illustration on previous page

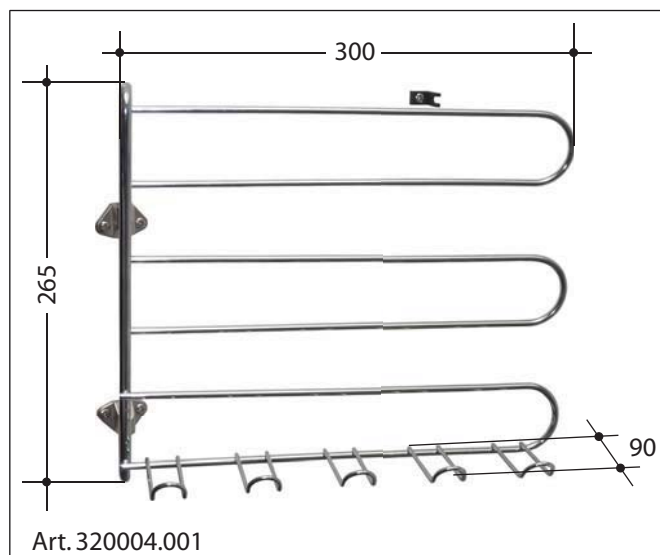

Belt- and Tieholder, swivel-type

300 x 265 x 90 mm (WxHxD), wire-thickness Ø 8 mm,
with 3 welded tie-hangers Ø 5 mm,
with 5 welded belt-hangers Ø 3 mm, depth 60 mm,

Material: Steel
Finish: chrome plated

Packing: Every single piece in polybag,
incl. fixing-material:

2 Fixing-plates, Zamak nickel plated
1 Plastic-clip, black
5 Wood-screws, steel nickel plated
(in separate polybag)

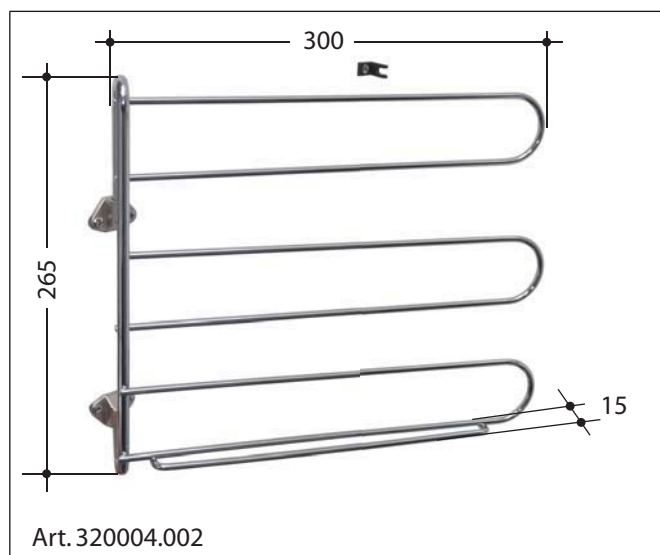

Belt- and Tieholder, swivel-type

300 x 265 x 45 mm (WxHxD), wire-thickness Ø 8 mm,
with 3 welded tie-hangers Ø 5 mm,
with 1 welded belt-hanger Ø 5 mm, depth 15 mm,

Material: Steel
Finish: chrome plated

Packing: Every single piece in polybag,
incl. fixing-material:

2 Fixing-plates, Zamak nickel plated
1 Plastic-clip, black
5 Wood-screws, steel nickel plated
(in separate polybag)

Installation

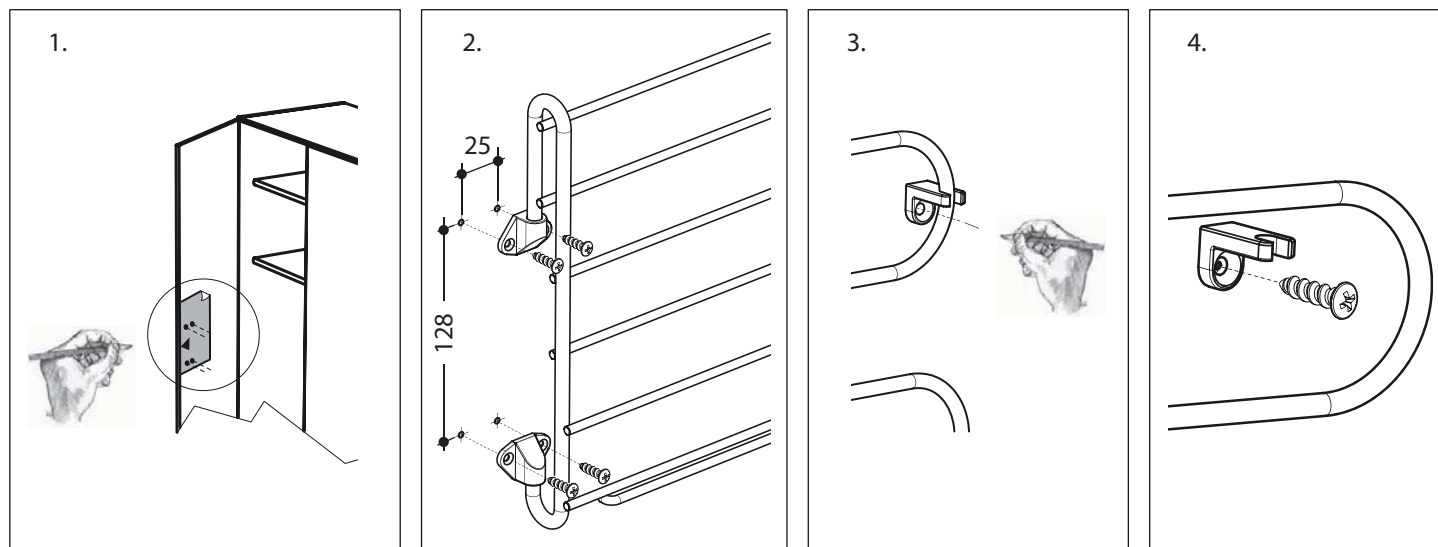



Piano hinge, holes, countersank, length acc. to customer instruction

Material: Stainless Steel 1.4301
Finish: natural

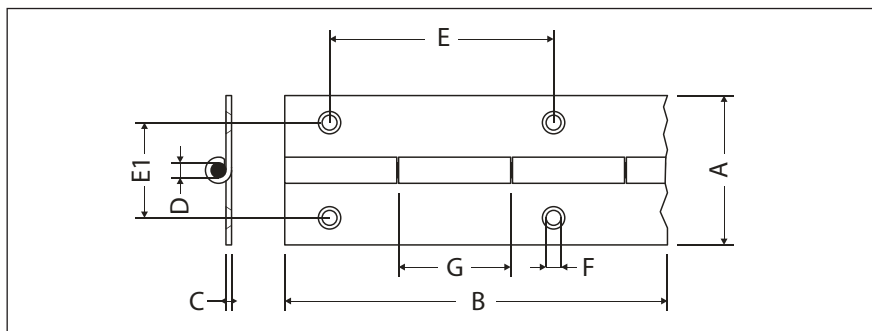

A	B	C	D	E	E1	F	G
16 - 60	1.980	0,7 - 3	1,5 - 9	60	9 - 29	2 - 6, 5	10 - 30



Hinge, Stainless Steel 1.4301

Finish: natural

A	B		A	B	C	D	G
30	40		50	60	1,5	4	5
40	40		50	80	1,5	4	5
40	60		60	80	1,5	4	5
40	80		80	80	1,5	4	5



Hinge, Stainless Steel 1.4301

Finish: natural

A	B	C	D	G
70	40	1,5	4	5



Hinge, Stainless Steel 1.4301

Finish: natural

A	B	C	D	G
80	20	1,5	4	5
90	30	1,5	4	5
100	40	1,5	4	5



Hinge, Stainless Steel 1.4301

Finish: natural

A	B	C	D	G
75	20	1,5	4	5
85	30	1,5	4	5
100	40	1,5	4	5

Other sizes, materials and versions can be supplied on demand.



Table hinge, Stainless Steel 1.4301

Finsh: natural

A	B	C	D	G
81,5	30	1,5	4	10

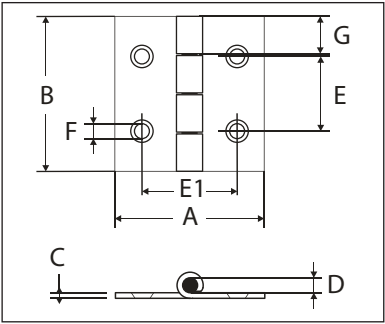

Hinge, Stainless Steel 1.4301

Finsh: natural

A	B	C	D	G
185	40	1,5	4	10



Hinge, Stainless Steel 1.4301

Finsh: natural

A	B	C	D	G
130	40	1,5	4	10



Hinge, Stainless Steel 1.4301

Finsh: natural

A	B	C	D	G
90	60	3	8	10



Hinge, Stainless Steel 1.4301

Finsh: natural

A	B	C	D	G
95	60	2	6	10

Other sizes, materials and versions can be supplied on demand.

Towel-holder, railing for wash-basin (acc. to customer drawing)

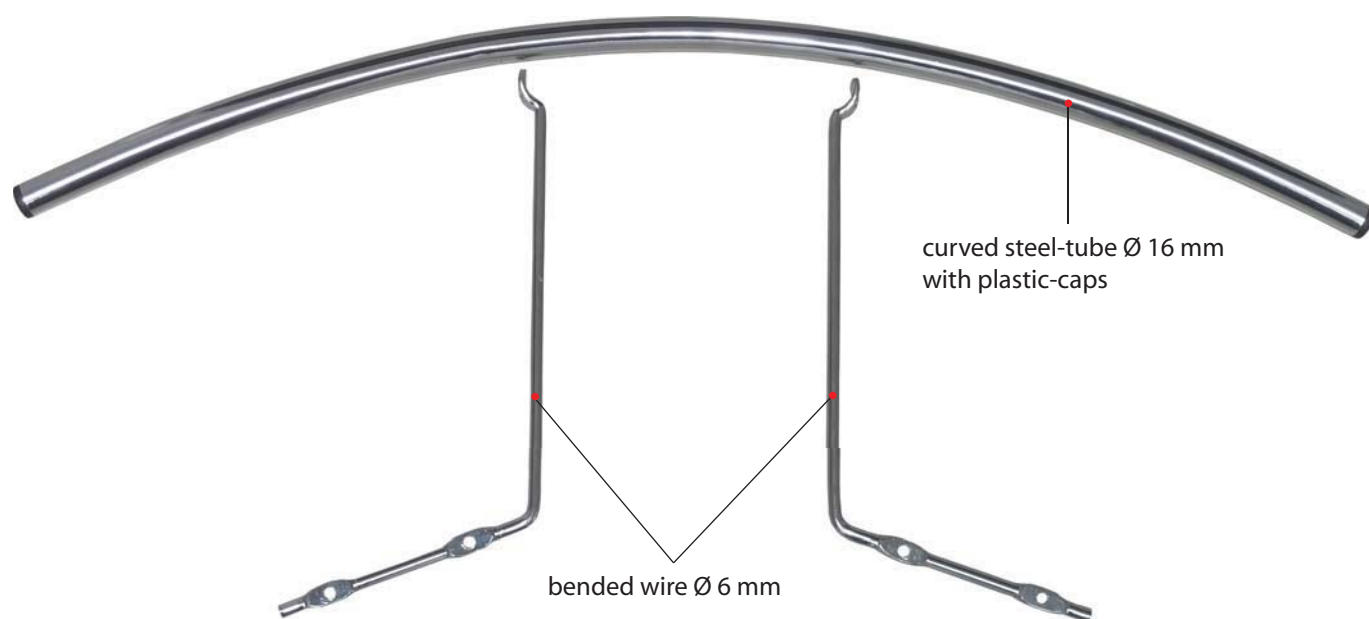

Art. 350001.001

Art. 571184 + 571185 + 571186



Folding-door hinge, cranked
50 x 50 mm, steel black zinc-plated



Art. 230030.101

Folding-door hinge, straight
50 x 42mm, steel zinc-plated



Art.-Nr.: 230030.002

Hinge with irregular flanges,
with cranking



Art. 230100.001

Height adjuster M10 x 55 mm

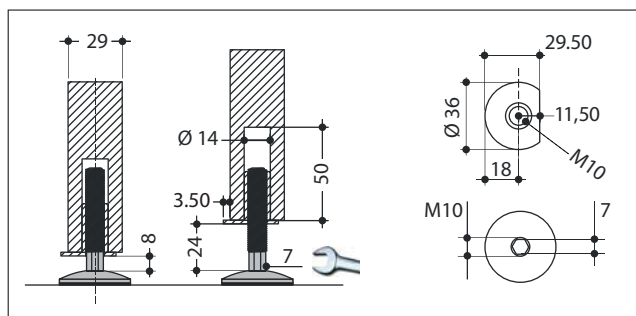

Height adjuster M8 x 110 mm

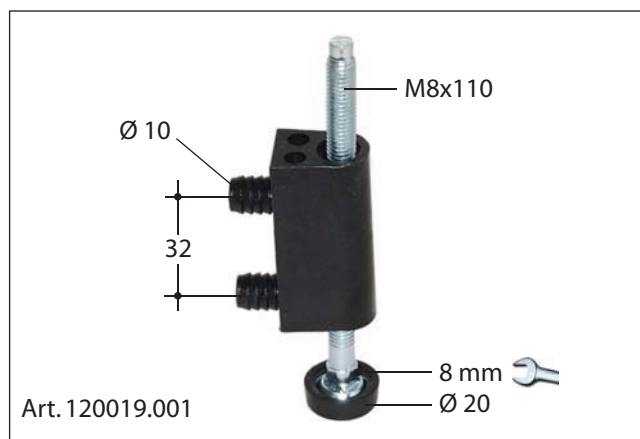

Spacer Ø 15 x 50 mm (M6)



Bar supports, made of steel-tube

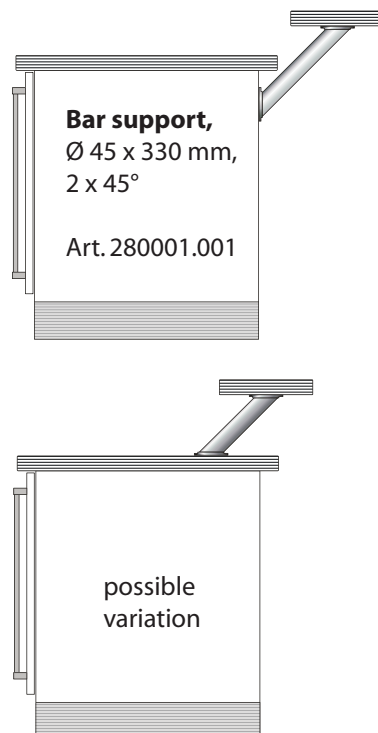

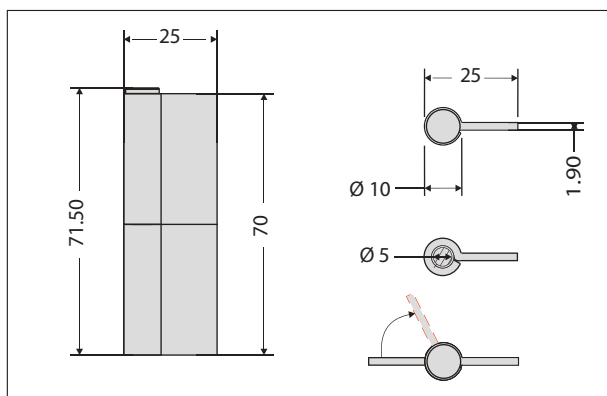

Weld-on hinge
stainless steel 1.4301
70 x 25 x 1,9 mm

one flange with fix pin,
one flange with decorative
head, without holes

Finish: plain



Hinge, rolled
stainless steel 1.4301

60 x 20 x 1 mm
with 4 holes Ø 4,5 mm,
without countersank

Finish: plain



Tarpaulin fastener
stainless steel 1.4016

41 x 11 x 12,5 mm

with 2 holes Ø 5 mm,
without countersank

BRACKETS STEEL/PLASTIC

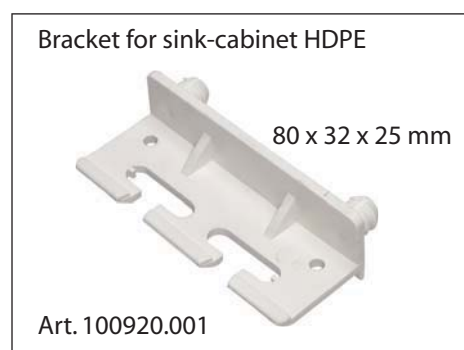
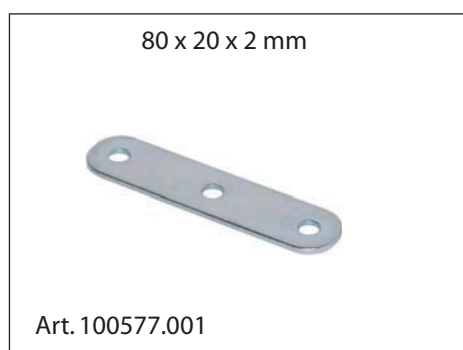

AHT-Beschläge GmbH
Technologie für Möbel
Lilienthalstrasse 16
D-42719 Solingen
Tel.: +49/212/3 83 77-0
Fax: +49/212/3 83 77-25
www.aht-beschlaege.de
info@aht-beschlaege.de



AHT-Beschläge GmbH
Tecnologia per mobili
Unità Locale Italia
S.P. Helvia Recina
I-62018 Potenza Picena (MC)
Tel.: +39/0733/784377
Fax: +39/0733/782178
e.tommaso@aht-beschlaege.de

