

SNAP-JOINTS
SCHNAPP-VERBINDER
ASSEMBLEURS RAPIDES
UNIONES EN CLIP

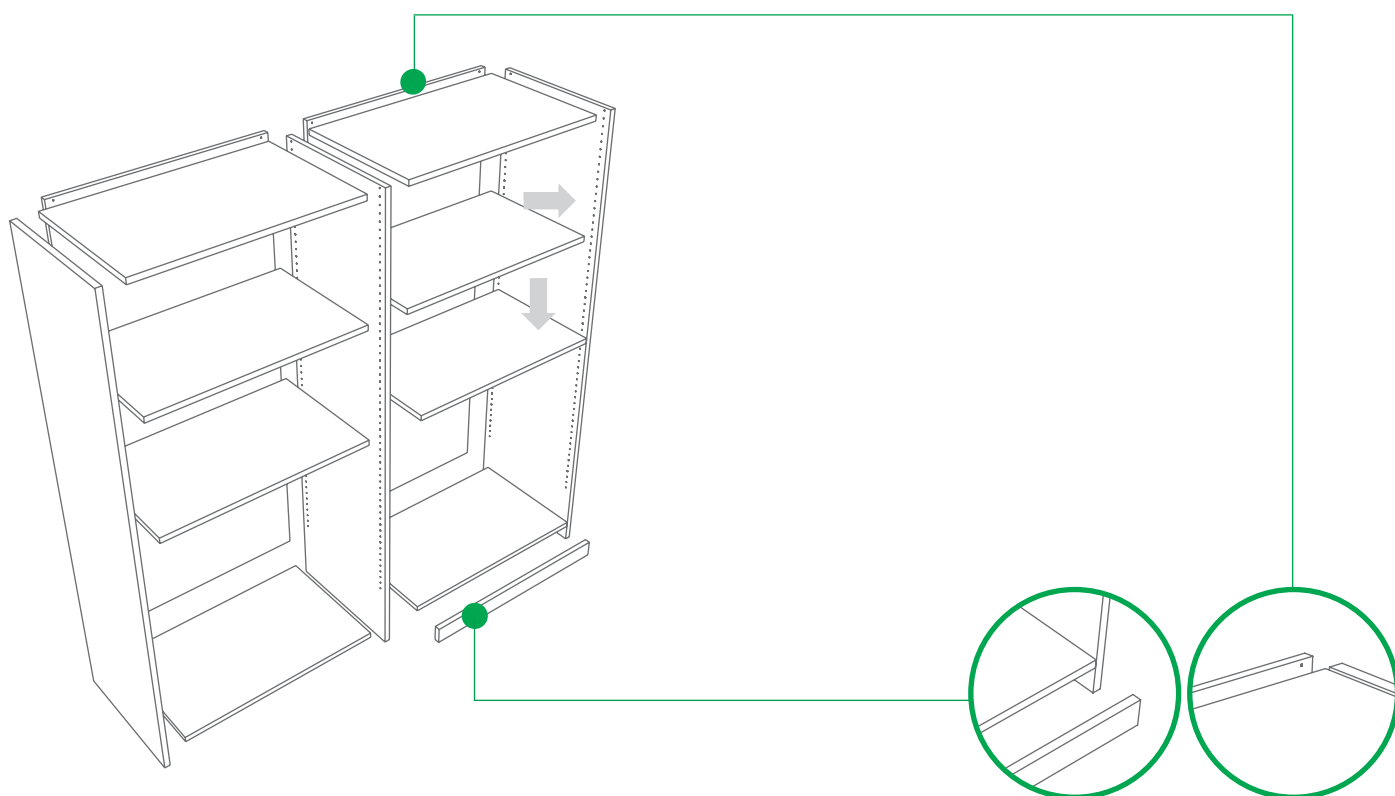

NORMAL 680	3 - 6
NORMAL 650	7 - 8
NORMAL 700 - 850	9 - 16

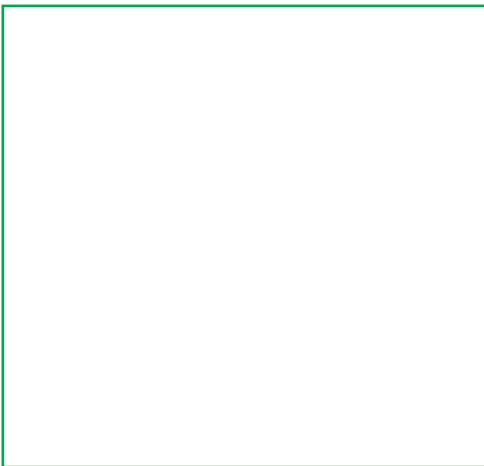
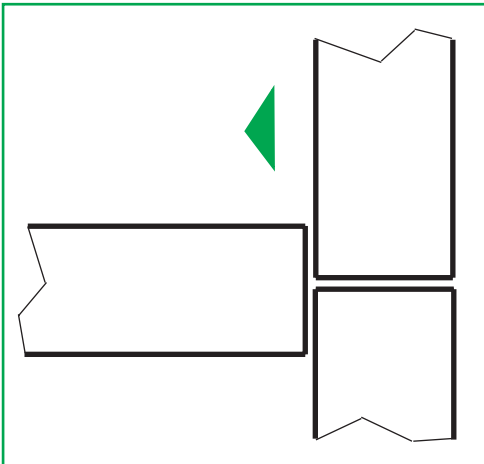

NORMAL
680
650

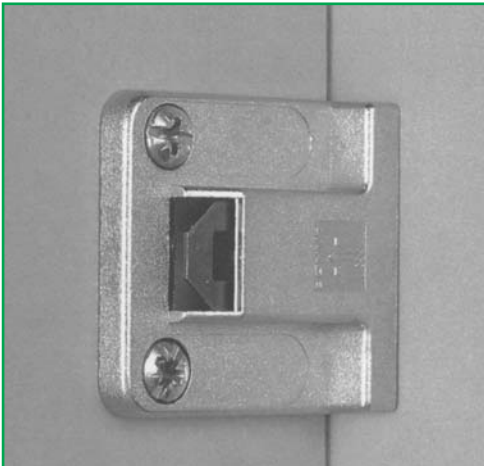



Esempi di applicazione

Assembly examples

Anwendungsbeispiele

Exemples d'utilisation

Ejemplos de aplicacion

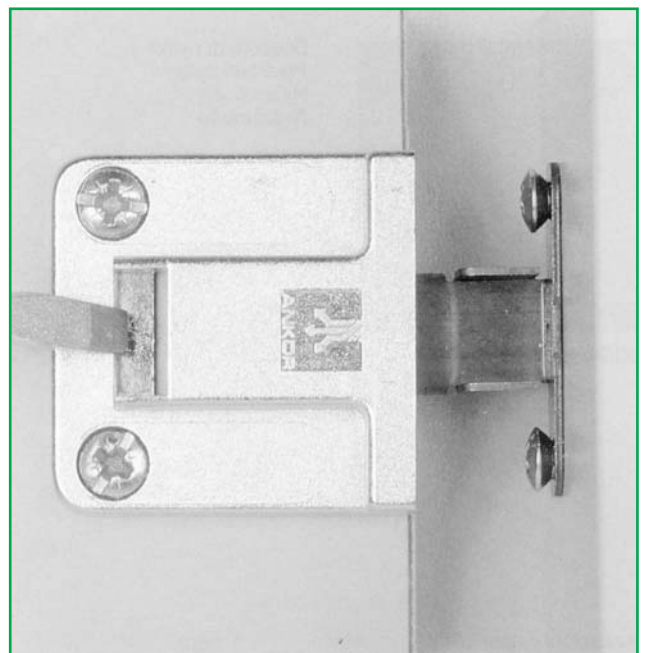
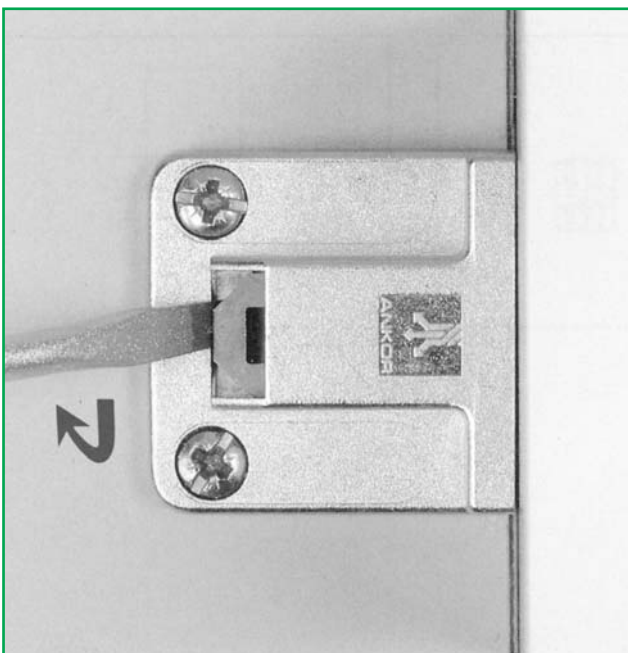



Femaschiena
Joint for furniture back
Rückwandverbinder
Jonction pour fond-arriere
Union para trasera

68SXX370036

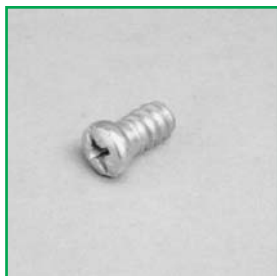
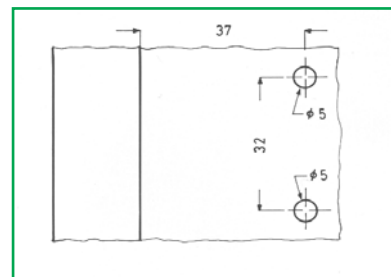
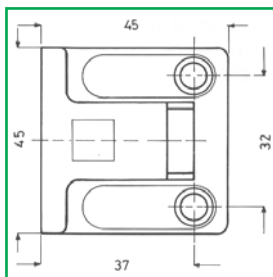
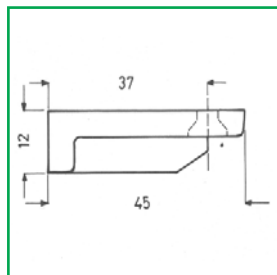

Vite EURO
EURO screw
Euroschraube
Vis EURO
Tornillo EURO

VTXTPEU1036



Molla di acciaio
Steel spring
Stahlsperfeder
Ressort en acier
Muelle de acero

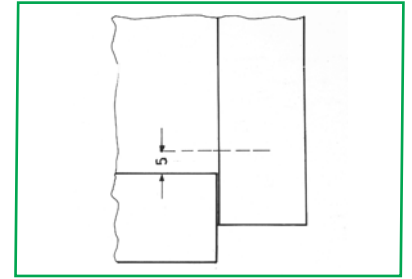
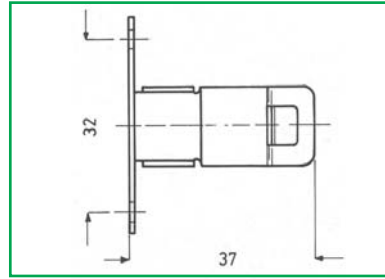

68MAC320035

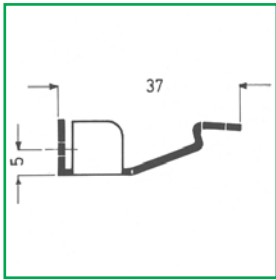

Vite 12 mm.
Screw 12 mm.
Schraube 12 mm.
Vis 12 mm.
Tornillo 12 mm.

VTXTS041236



Bussola estraibile
Extractable bush
Heraiziehbare Muffe
Insert amovible
Tuerca extraible

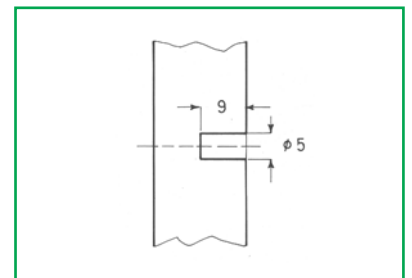
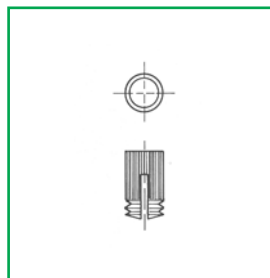

BUEX0409030

M4 X 9



Bussola senza pastiglia
Bush without pellet
Muffe ohne Nylonzylinder
Insert amovible sans pastille
Tuerca sin bola

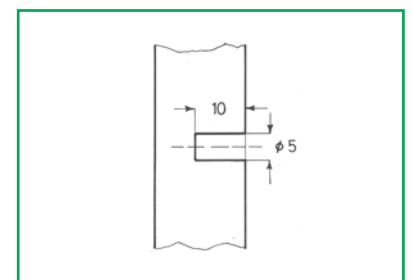
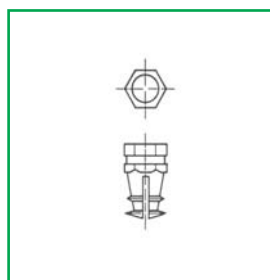

BUXX0410030

M4 X 10

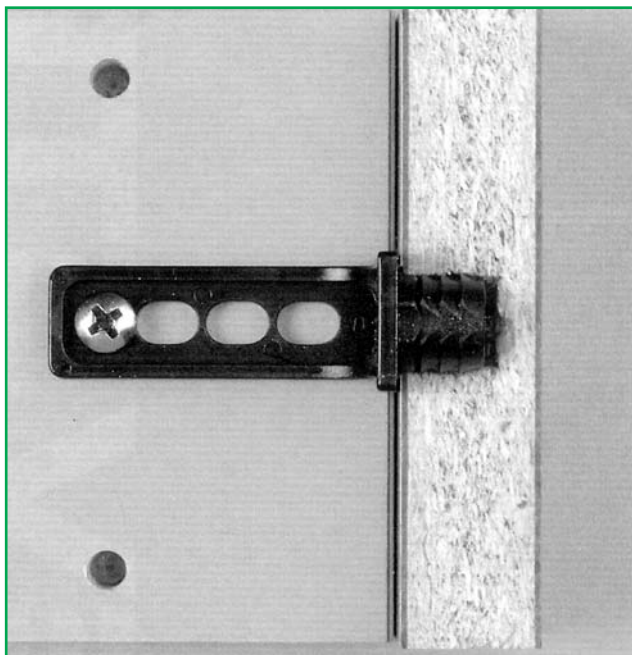

Giunti per l'assemblaggio delle schiene

Joints for assembling furniture backs

Rückwandverbinder

Jonctions pour l'assemblage des panneaux de fond-arrière

Uniones para traseras



Feraschiena

Joint for furniture back
Rückwandverbinder
Jonction pour fond-arrière
Union para trasera

65XPL3700

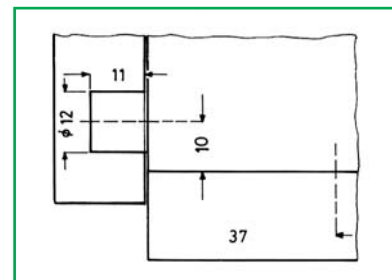
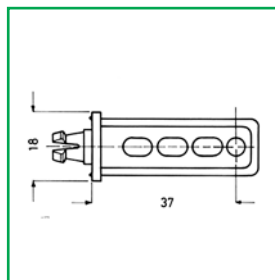
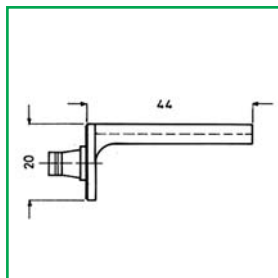

Esecuzioni disponibili

Available finishings

Farbe

Finitions disponibles

Colores

bianco

white

weiss

blanc

blanco

nero

black

01 schwarz

noir

negro



Bussola di nylon

Nylon bush

Nylonmuffe

Insert en nylon

Tuerca de nylon

BXXPL1211

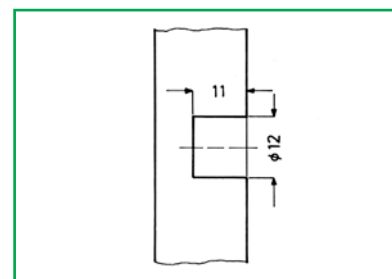
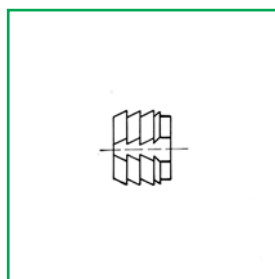

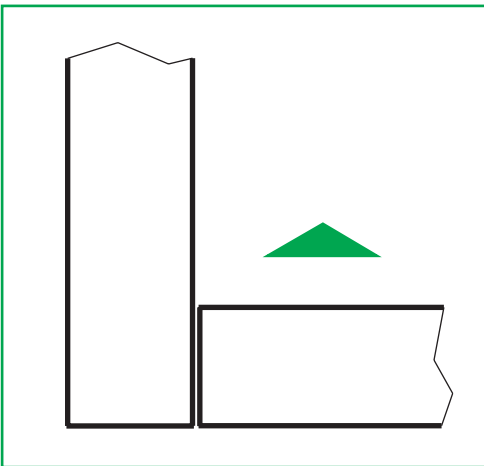
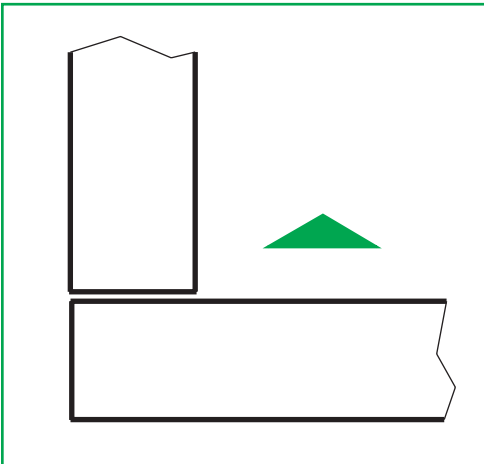

NORMAL

- 700
- 720
- 750
- 770
- 800
- 850

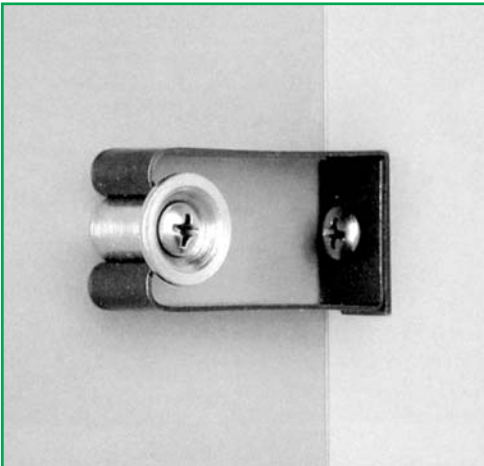

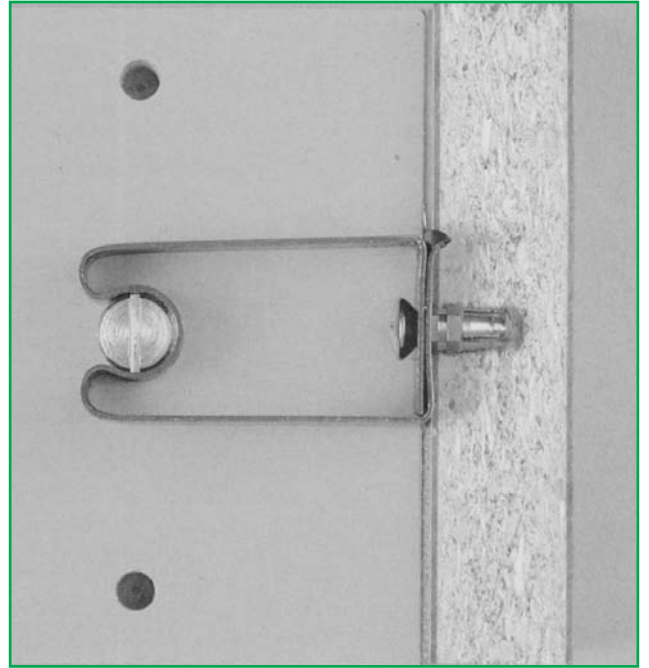
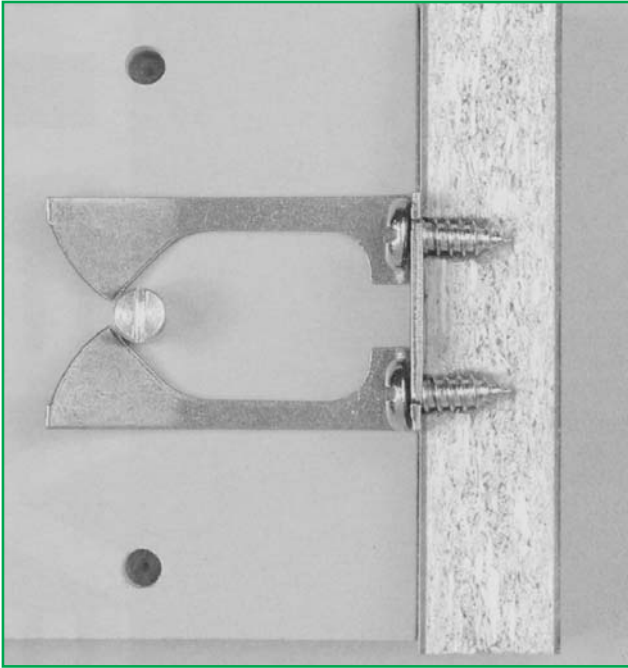

Giunti per l'assemblaggio delle zoccolature

Joints for assembling baseboards

Sockelbefestigung

Jonctions pour l'assemblage des socles

Uniones para zocalos

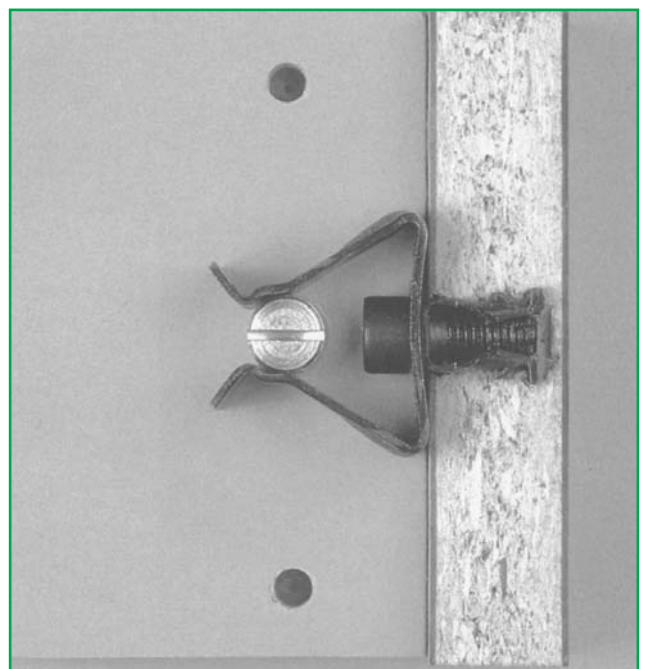
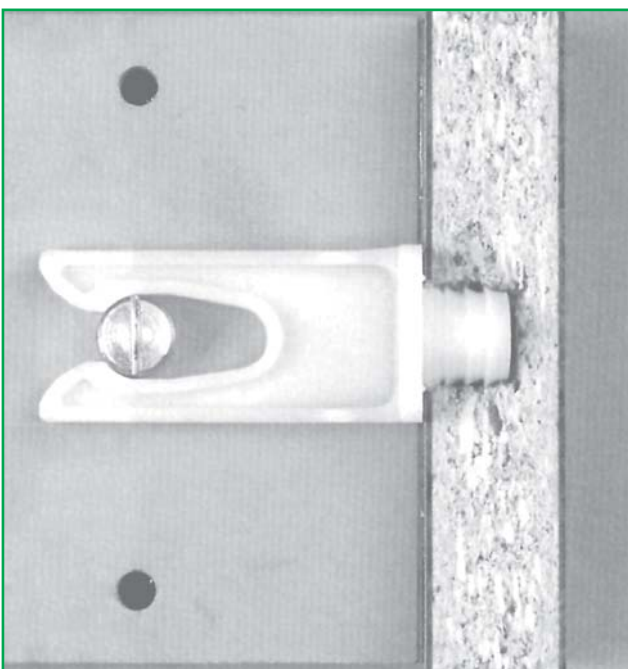

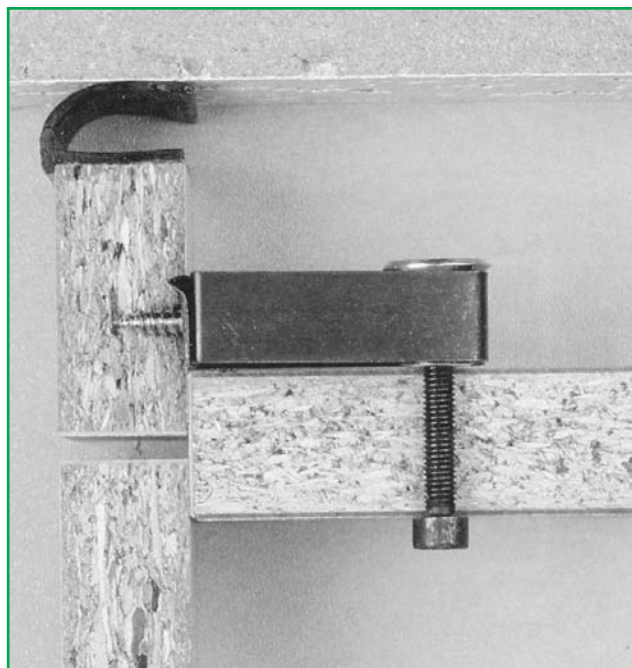
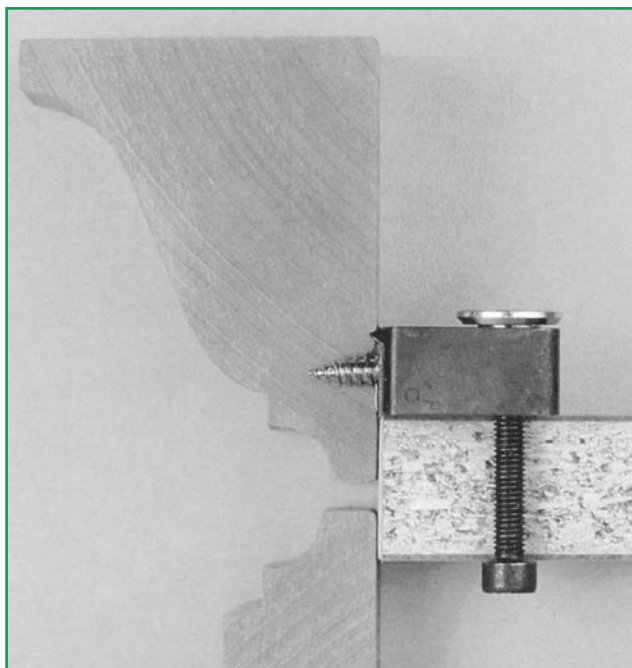

Esempi di applicazione

Assembly examples

Anwendungsbeispiele

Exemples d'utilisation

Ejemplos de aplicacion

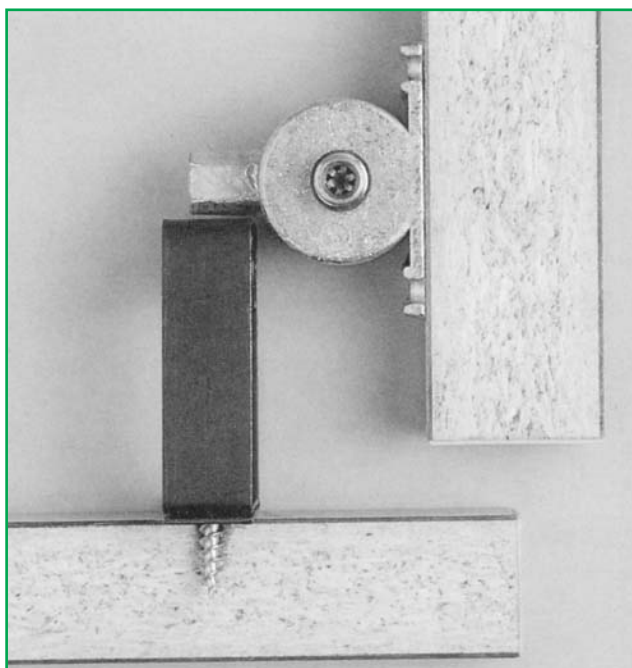



Molla di acciaio
Steel spring
Stahlsperfeder
Ressort en acier
Muelle de acero

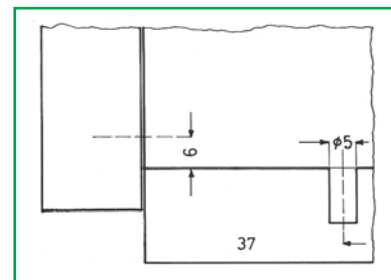
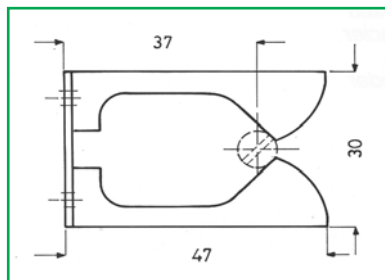

70XAC370035

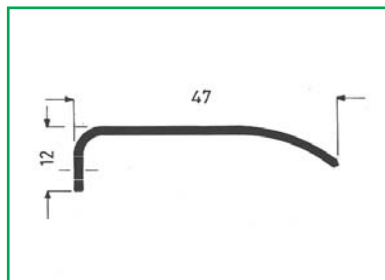
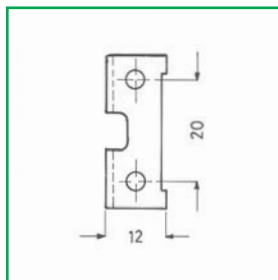

Perno filetto mordente
Bolt with raised thread
Gewindebolzen zum direkten Einschrauben
Tige avec filet auto-filetant
Perno rosca madera

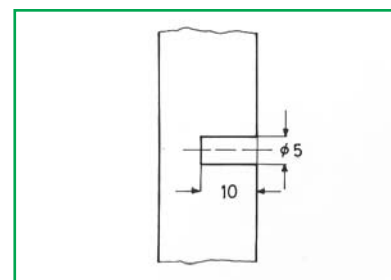
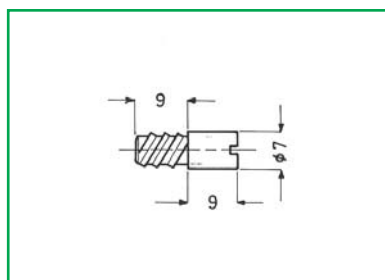

70PML050731



Molla di acciaio
Steel spring
Stahlsperfeder
Ressort en acier
Muelle de acero

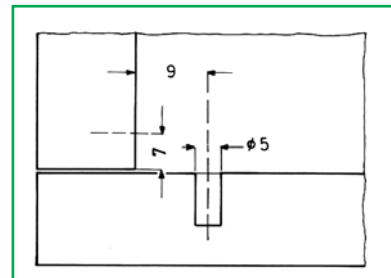
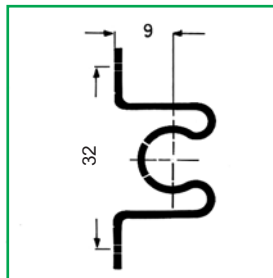

72XAC090035

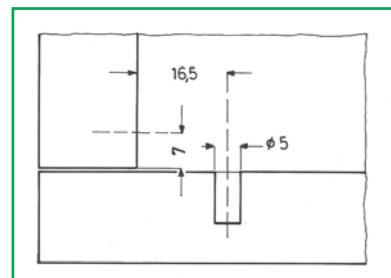
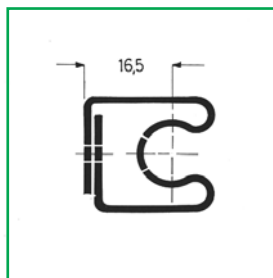
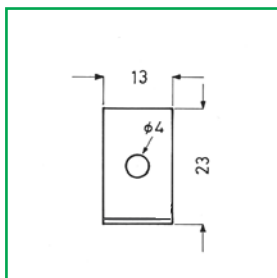

72XAC165035

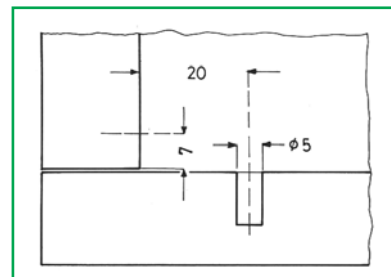
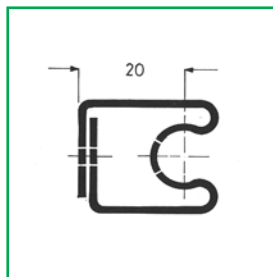

72XAC200035

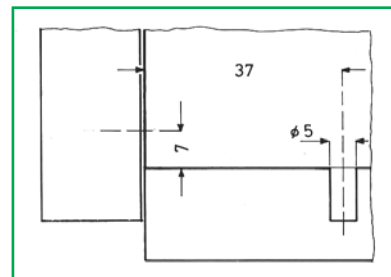
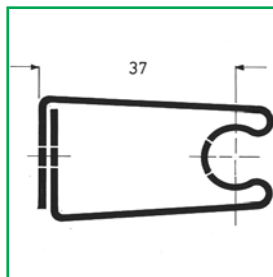

72XAC370035



Perno filetto mordente
Bolt with raised thread
Gewindebolzen zum direkten Einschrauben
Tige avec filett auto-filetant
Pernio rosca madera

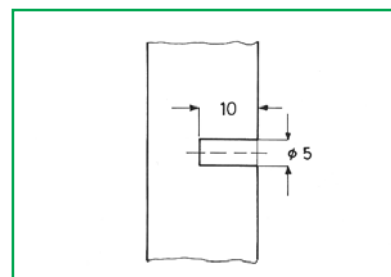
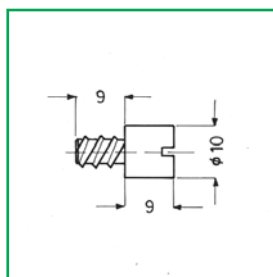

7XPML051031



Perno con flangia
Bolt with collar
Bolzen mit Rand
Tige avec bord
Pernio con borde

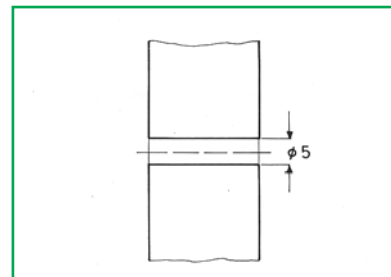
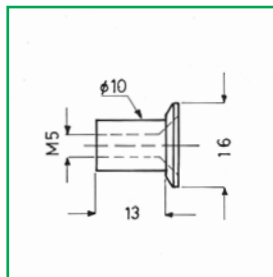

7XPMT05FE31

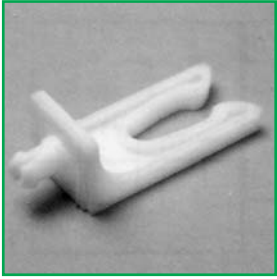

Molla di nylon
Nylon spring
Nylonsperrfeder
Ressort en nylon
Muelle de nylon

75XPL370001

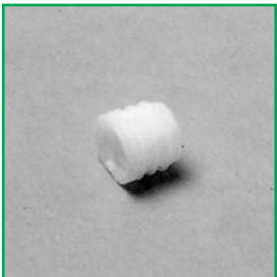
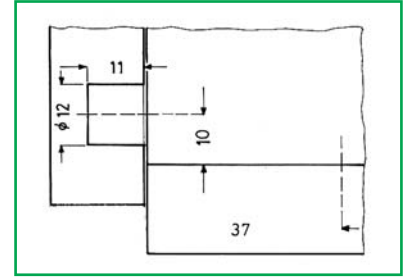
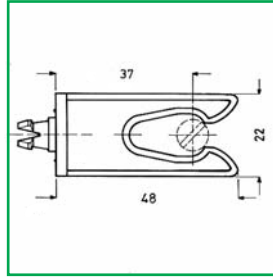
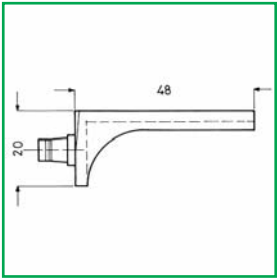

Bussola di nylon
Nylon bush
Nylonmuffe
Insert en nylon
Tuerca de nylon

BXXPL121101

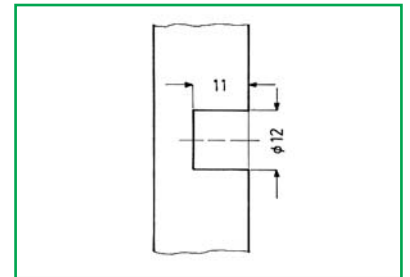
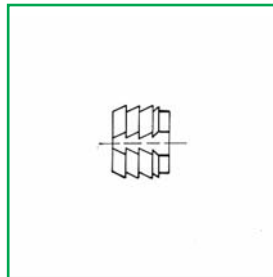

Perno filetto mordente
Bolt with raised thread
Gewindebolzen zum direkten Einschrauben
Tige avec filet auto-filetant
Perno rosca madera

7XPML051031

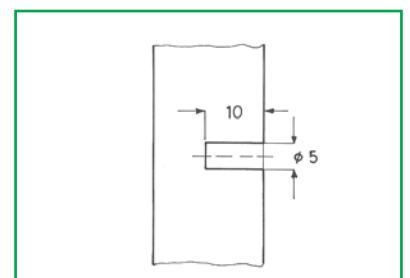
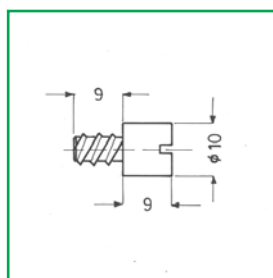



Molla di acciaio
Steel spring
Stahlsperfeder
Ressort en acier
Muelle de acero

77XAC180035

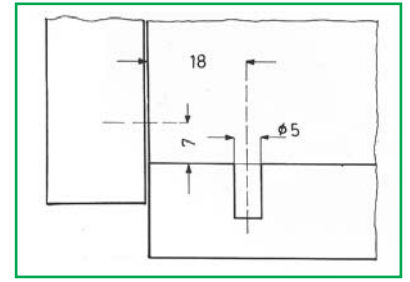
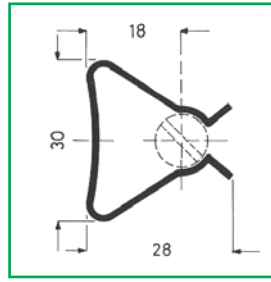
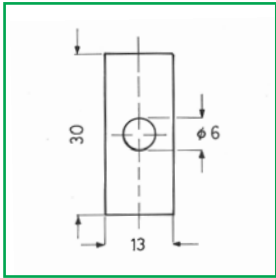

Molla di acciaio
Steel spring
Stahlsperfeder
Ressort en acier
Muelle de acero

77AAC180035

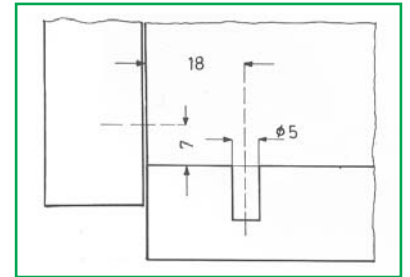
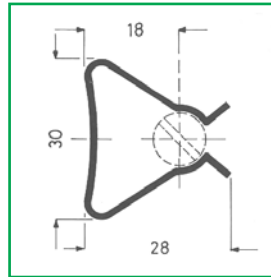
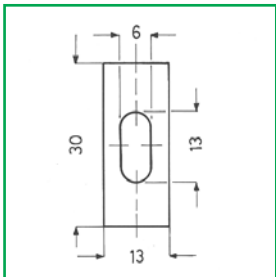

Perno filetto mordente
Bolt with raised thread
Gewindebolzen zum direkten Einschrauben
Tige avec filett auto-filetant
Pernio rosca madera

7XPML051031

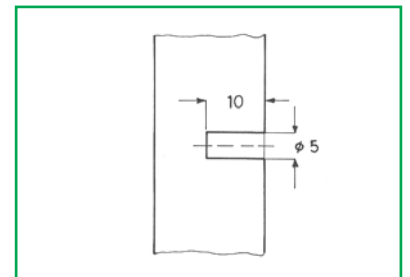
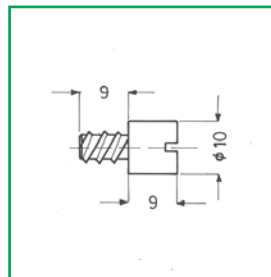

Perno con flangia
Bolt with collar
Bolzen mit Rand
Tige avec bord
Pernio con borde

7XPMT05FE31

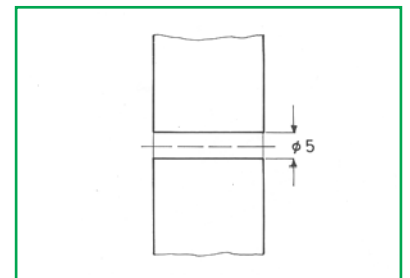
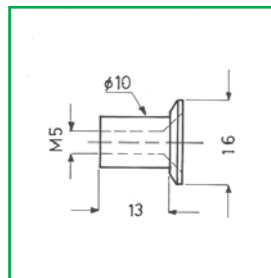



Doppia spina a scatto
Double-click pin
Doppelseitiger Clipverbinder
Double cheville à clip
Doble taco a clip

80MPL000002

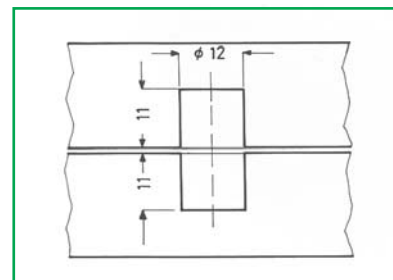
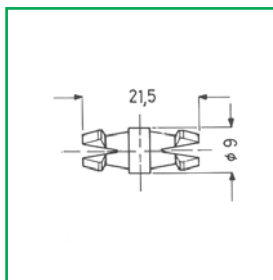
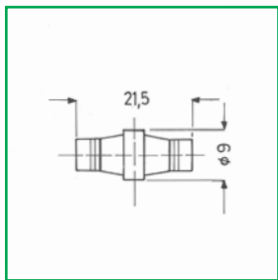

Bussola di nylon
Nylon bush
Nylonmuffe
Insert en nylon
Tuerca de nylon

BXXPL121102

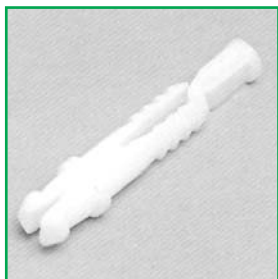

Spina a scatto
Click pin
Einseitiger Clipverbinder
Cheville à clip
Taco a clip

85MPL000001

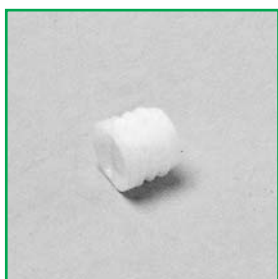
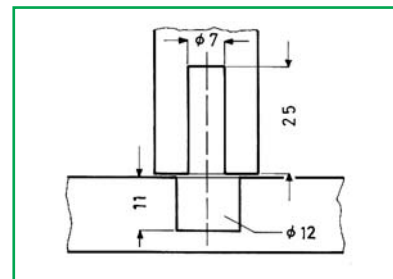
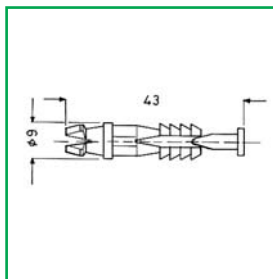
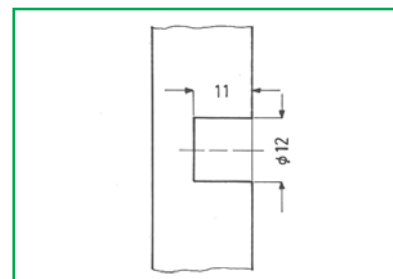
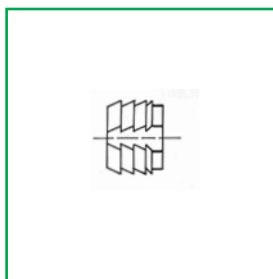
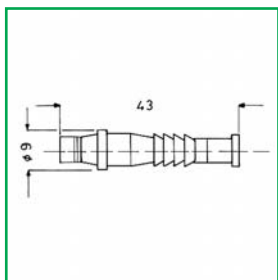

Bussola di nylon
Nylon bush
Nylonmuffe
Insert en nylon
Tuerca de nylon

BXXPL121101

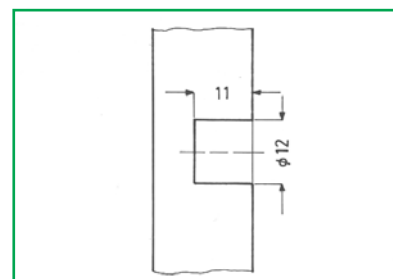
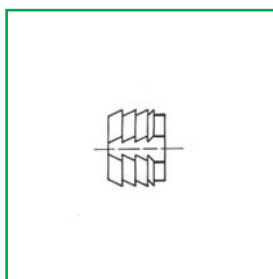

L'azienda si riserva di apportare modifiche estetiche o funzionali ai prodotti senza preavviso. Aesthetics and functional changes can be made without prior notice.

GIUNTI A SCATTO

SNAP-JOINTS
SCHNAPP-VERBINDER
ASSEMBLEURS RAPIDES
UNIONES EN CLIP

EFFEGI BREVETTI s.r.l.

20090 Segrate (MI) - tel. +39 02 26921838 - fax +39 02 26921737 - www.effegibrevetti.it - e-mail infofg@effegibrevetti.it